



# Surgical Technique

*Wise-Lock Modular Hand & Foot System*

## Intended Use and Indications

### Intended Use

Wise-Lock Compact Hand Implants are intended for temporary fixation, correction or stabilization of bones in anatomical region of the distal radius and hand

### Indications

#### Wise-Lock Compact Hand 1.5

- Fracture fixation of the phalanges and metacarpals
- Osteotomies
- Arthrodeses
- Replantations and reconstructions of phalanges and metacarpals, particularly in osteopenic bone

#### Wise-Lock Compact Hand 2.0

- Fractures of the phalanges, metacarpals and wrist bones
- Osteotomies and arthrodeses of the interphalangeal joints
- Fractures of distal radius (double-plate technique)
- Subcapital radial head fractures

#### Wise-Lock Compact Hand 2.4

- Fractures of the metacarpal and wrist bones
- Fractures of distal radius (double-plate technique)
- Osteotomies and arthrodeses on the hand
- Subcapital radial head fractures

## Fracture Reduction and Plate Contouring

### Reduce fracture

- ① Reduce the fracture under image intensification and, if necessary, fix with Kirschner wires or reduction forceps. The reduction method is fracture-specific.

### Trim plate

Trim the plate to the desired length using bending/cutting pliers. Remove the burrs.



## Contour plate

If necessary, contour the plate to suit the anatomical conditions.

### Standard plates

Use bending pins for Wise-Lock Plates and thread the pins into the screw holes to contour the plate. (1)



The plate can also be bent using two flat nosed pliers. (2)

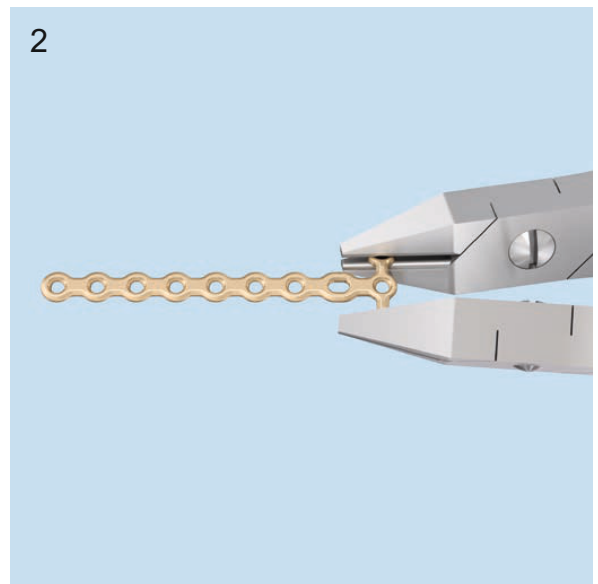

### Preassembled plates

(Wise-Lock Compact Hand 1.5 only)

Use the non-threaded ends of the bending pins over the short threaded drill sleeves. (3)

### Precautions:

- If possible, bend the plate between the locking/Wise-Lock holes. Do not deform the threaded part of the holes or over-bend the plate as this may adversely affect insertion of locking screws. Avoid repetitive bending of the plate.
- Reverse bending or use of the incorrect instrumentation for bending may weaken the plate and lead to premature plate failure (e.g. breakage). Do not bend the plate beyond what is required to match the anatomy.

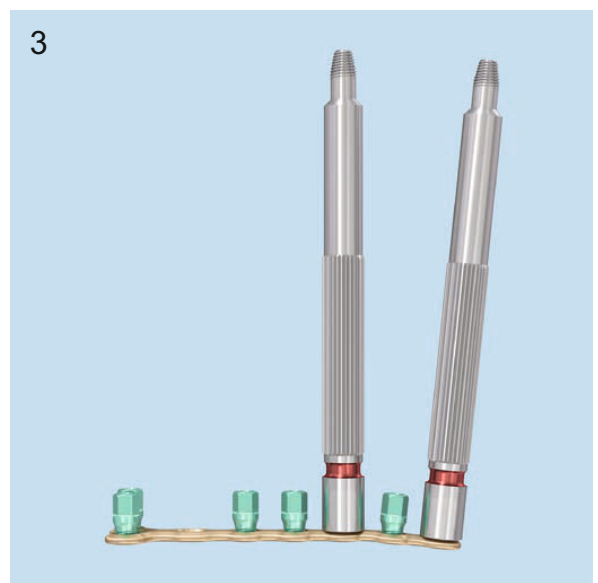

## Fracture Reduction and Plate Contouring

### Position plate

Position the plate over the reduced fracture and, if necessary fix provisionally with Kirschner wires or reduction forceps. (1)

### Preassembled plates

(Wise-Lock Compact Hand 1.5 only)

When using reduction forceps with points on a preassembled plate, insert one branch of the forceps in the cannulation of the short drill sleeve to secure the plate to the bone. (2)

When using the holding forceps with swivel foot to hold the plate, remove the drill sleeves from the surrounding holes so that the holding forceps sit flush on the plate.

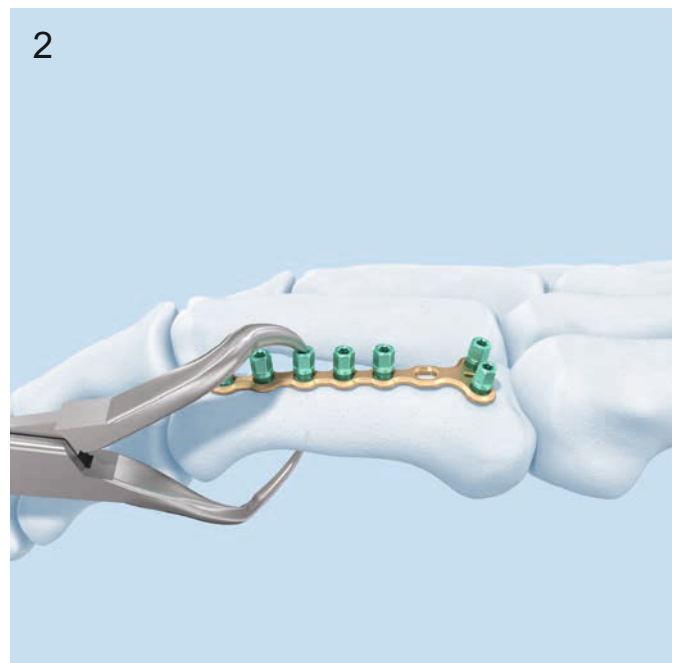
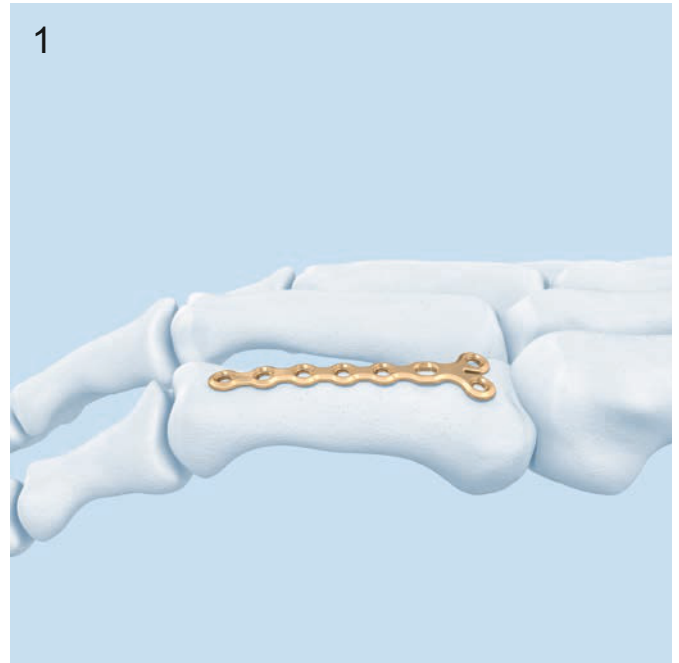

## Screw Insertion

### Determine screw type

Depending on the individual case, cortical and/or Wise-Lock screws may be inserted. Determine where Wise-Lock screws and where cortical screws will be used.

The final screw placement and the use of Wise-Lock and cortical screws are determined by the fracture pattern.

If a Wise-Lock screw is inserted first, ensure that the plate is held securely to the bone to prevent the plate from spinning as the screw locks into the plate.

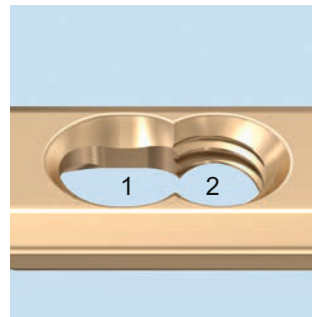

**Wise-Lock combi-hole:**  
cortical screw in the compression portion (1), Wise-Lock screw in the threaded portion of the hole (2)

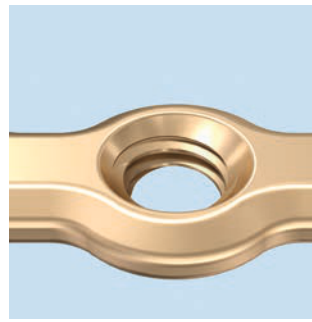

**Locking hole:**  
cortical or Wise-Lock screw

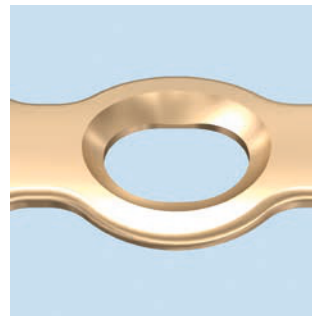

**Compression hole:**  
Cortical screw only

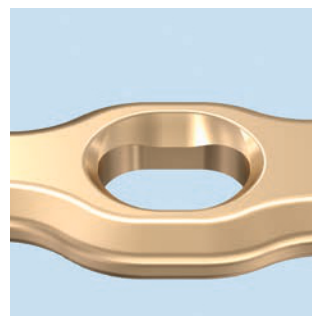

**Elongated compression hole:**  
Cortical screw only

### Standard plates

Drill the screw hole using the drill bit and the corresponding drill guide / drill sleeve. (1)

Use the following drill diameter for the threaded respectively the gliding hole:

	Threaded hole	Gliding hole
Compact Hand 1.3	1.0	1.3
Compact Hand 1.5	1.1	1.5
Compact Hand 2.0	1.5	2.0
Compact Hand 2.4	1.8	2.4

When using a Wise-Lock hole, drill the screw hole either neutrally or off-centre (compression).

### Preassembled plates

(Wise-Lock Compact Hand 1.5 only)

Drill the screw hole using the short Wise-Lock drill sleeves that are preassembled to the plate. To drill for a Cortical screw in an angle other than 90° to the plate, use the double drill guide. Before using the double drill guide, remove the short drill sleeve. (2)

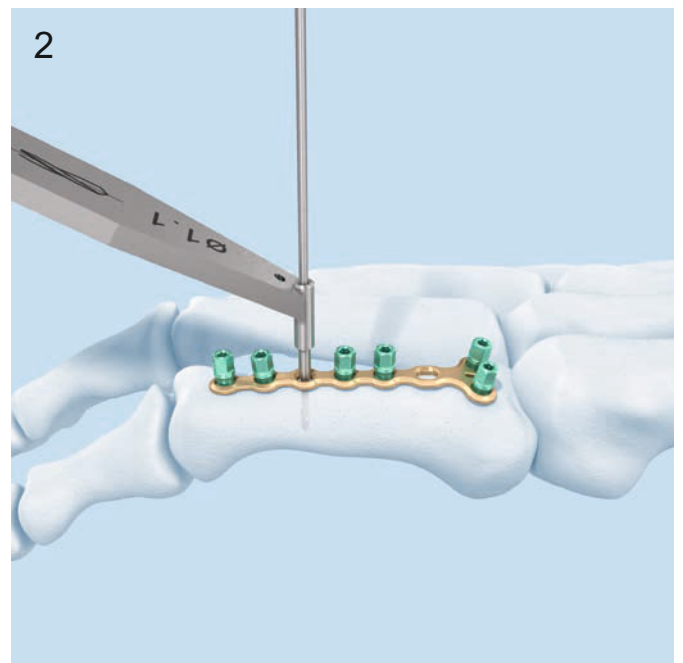
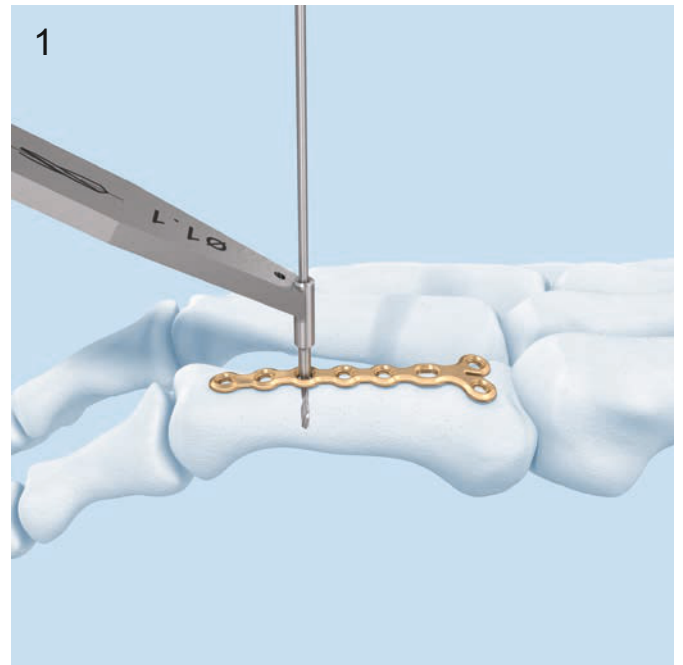

## Screw Insertion Cortical Screws

### Determine screw length of Cortical screw

#### Standard plates

Determine the screw length with the corresponding depth gauge. (1)

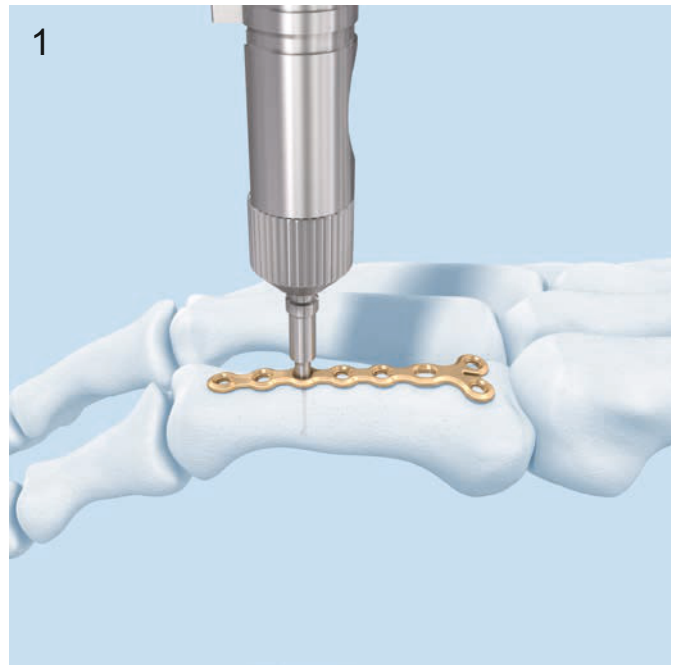

**Preassembled plates**

(Wise-Lock Compact Hand 1.5 only)

Screw length may be measured either with or without the short drill sleeve assembled to the plate (2, 3). When measured directly through the drill sleeve, subtract 5 mm from the reading to account for the drill sleeve. (3)

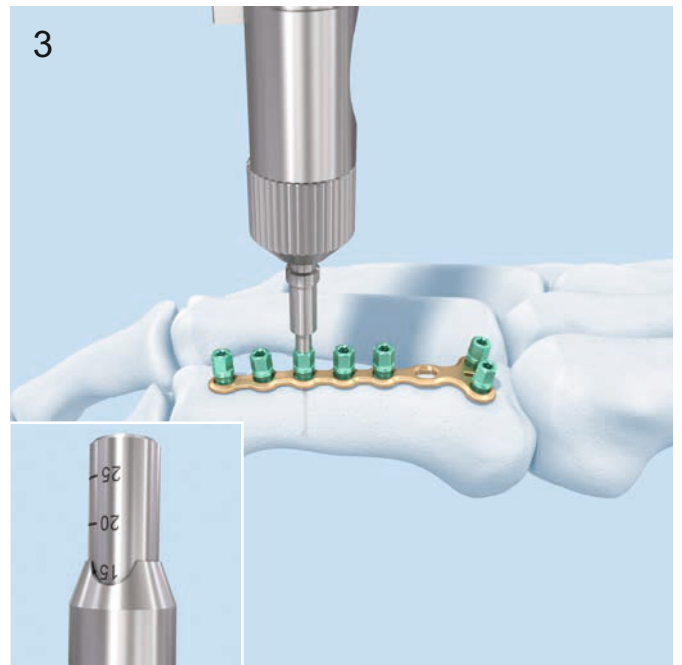
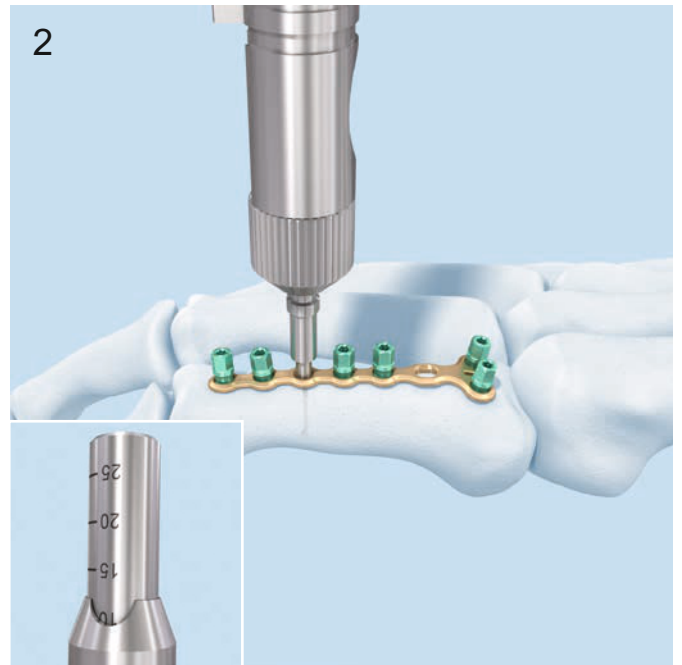



## Screw Insertion Cortical Screws

### Insert cortical screw

#### Standard plates

Insert the self-tapping cortical screw using the corresponding screwdriver. (1)

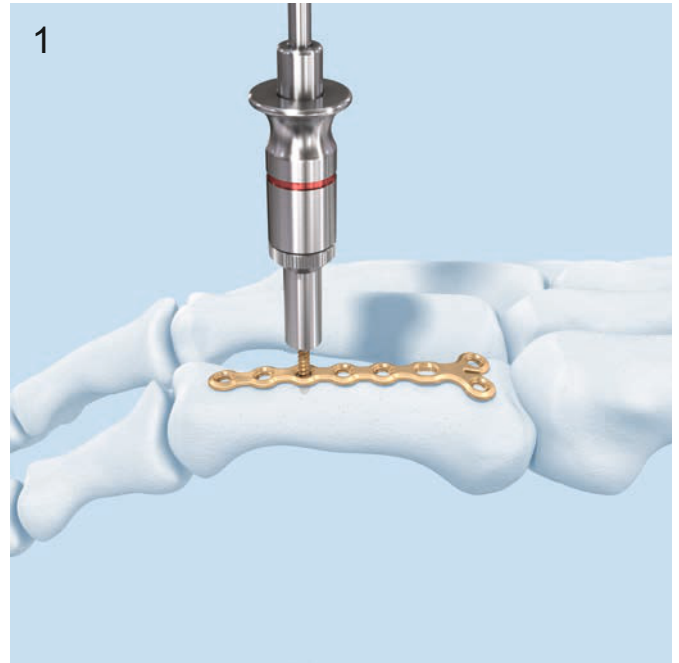

### Preassembled plates

(Wise-Lock Compact Hand 1.5 only)

Remove preassembled short drill sleeves. A tray which can help removing the short drill sleeves from the screwdriver is optionally available. (2)

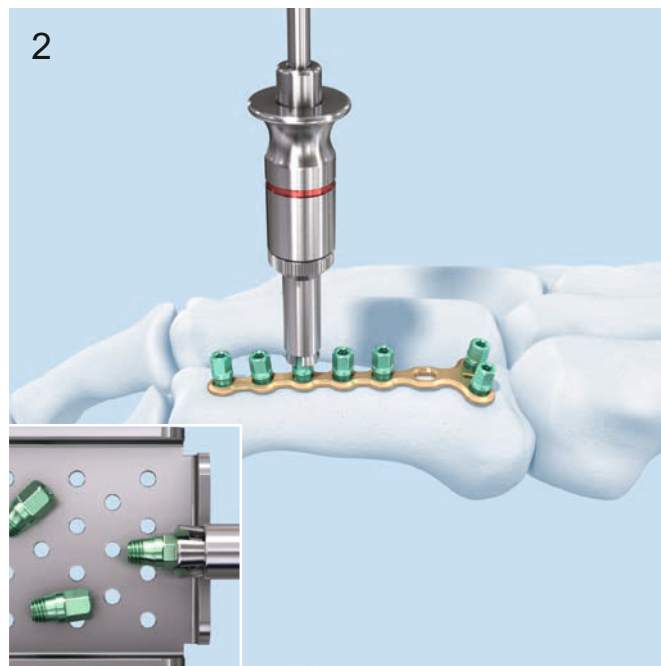

Insert the self-tapping cortical screw using the corresponding screwdriver. (3)

### Notes:

- It is recommended to count the short Wise-Lock drill sleeves to ensure they are all removed before closure.

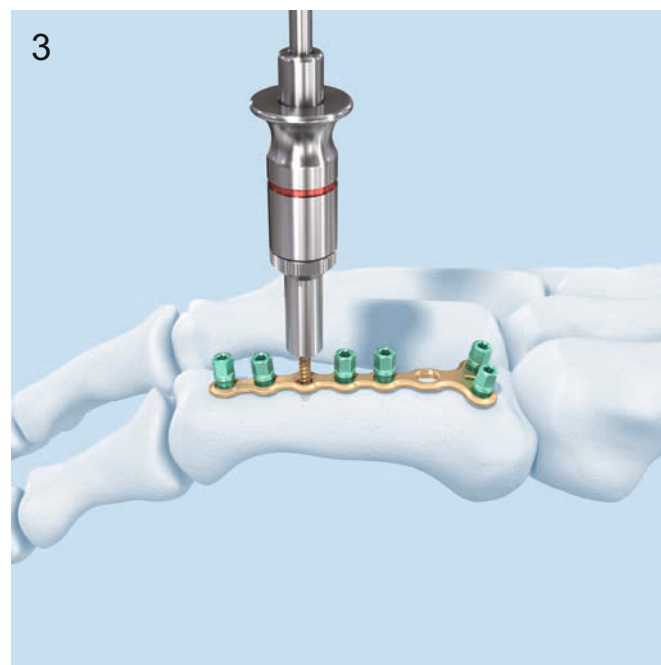

## Screw Insertion Wise-Lock Screws

### 1

#### Pre-drill screw hole for locking screw

##### Standard plates

Drill screw hole through the Wise-Lock drill sleeve using the appropriately sized drill bit. (1)

##### Preassembled plates

(Wise-Lock Compact Hand 1.5 only)

Drill the screw hole using the short Wise-Lock drill sleeves that are preassembled to the plate. (2)

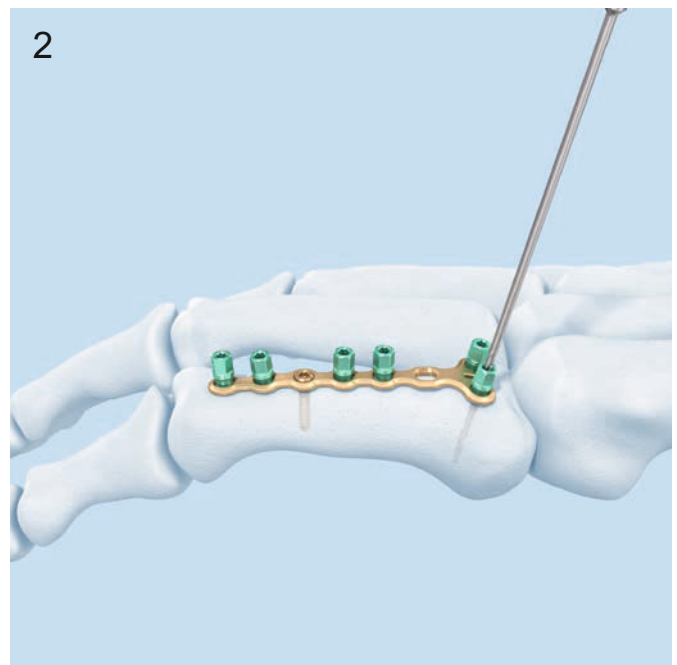
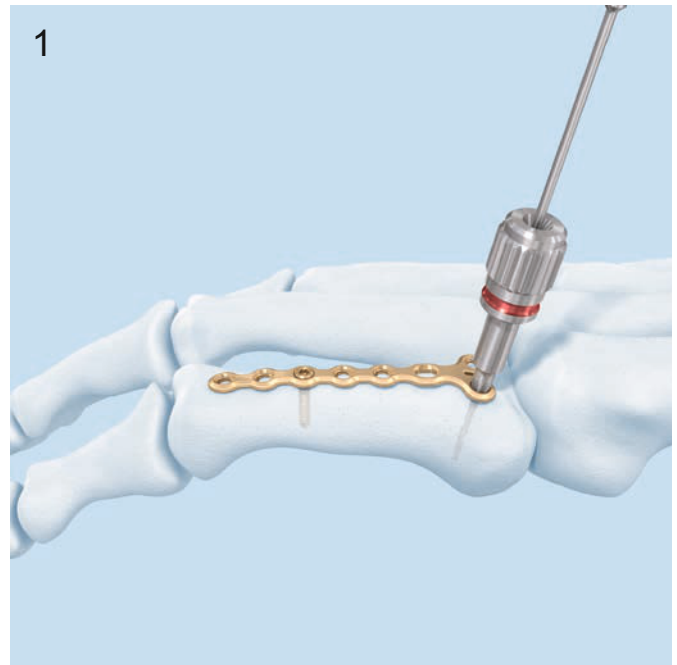

**Determine screw length of Wise-Lock screw  
Standard plates**

Determine the screw length either with the corresponding depth gauge (1) or with the Wise-Lock drill sleeve (Wise-Lock Compact

Hand 2.0/2.4, marking on drill bit). (2)

When using the Wise-Lock drill sleeve check the length directly on the scale of the drill sleeve. Then remove the drill sleeve.

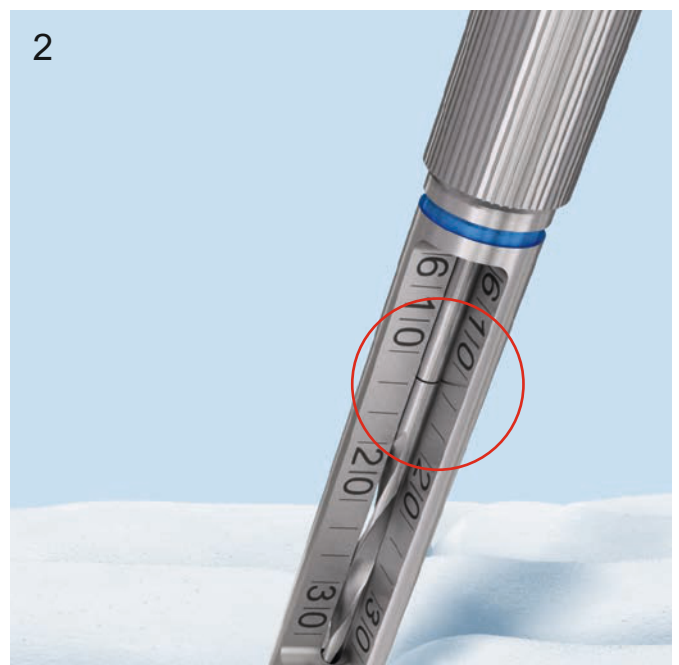
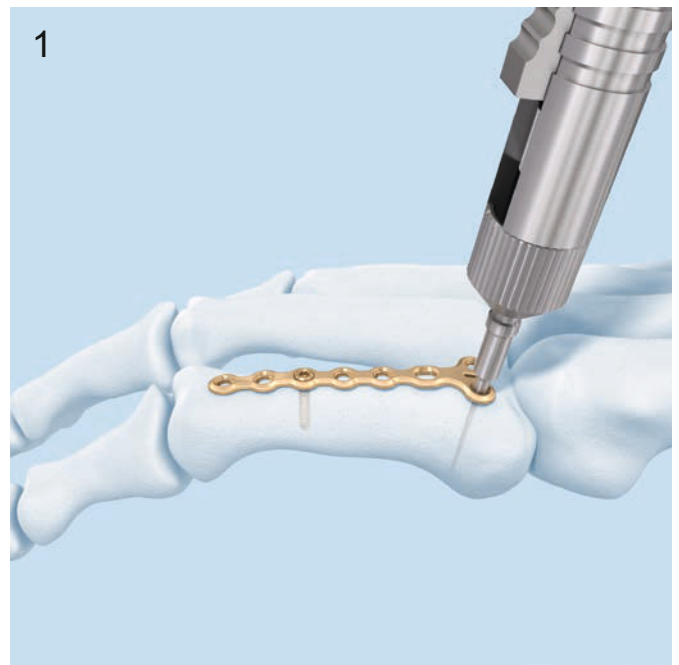

Screw Insertion  
Wise-Lock Screws

**Preassembled plates**

(Wise-Lock Compact Hand 1.5 only)

Screw length may be measured either with or without the short drill sleeve assembled to the plate. When measured directly through the drill sleeve, subtract 5 mm from the reading to account for the drill sleeve. (3)

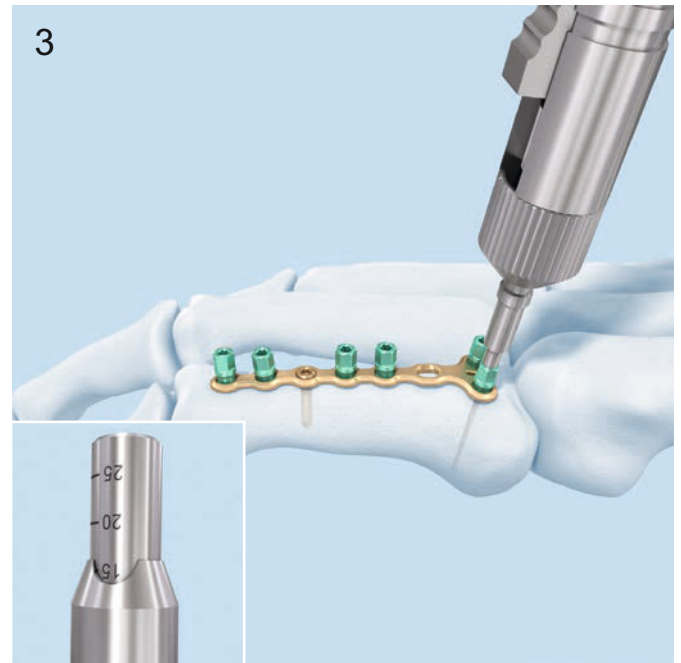

### Insert Wise-Lock screw

#### Standard plates

Insert the self-tapping Wise-Lock screw using the corresponding screwdriver shaft and the appropriate handle. (1)

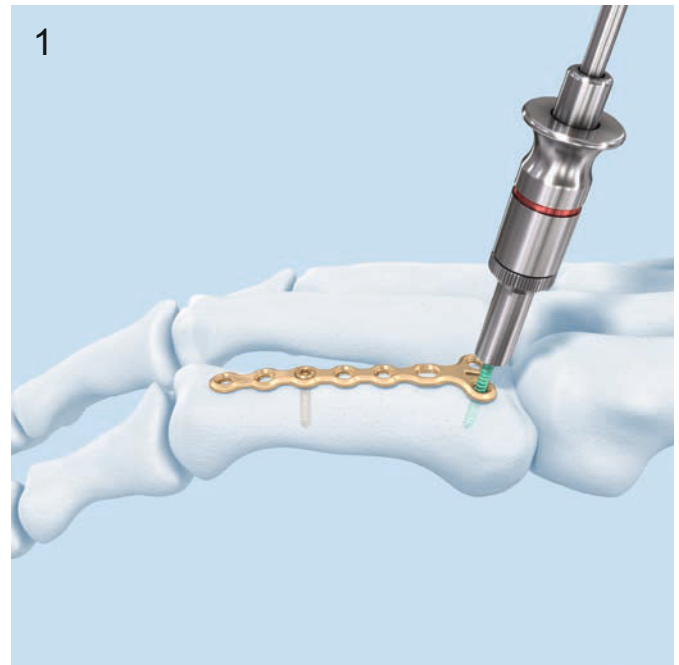

Screw Insertion  
Wise-Lock Screws

---

**Preassembled plates**

(Wise-Lock Compact Hand 1.5 only)

Remove preassembled short drill sleeves. Insert the self-tapping Wise-Lock screw using the corresponding screwdriver. (2)

A tray which can serve as a tool to help removing the short drill sleeves from the screwdriver is optionally available.

---

**Note:** It is recommended to count the short Wise-Lock drill sleeves to ensure they are all removed before closure.

---

**Wise-Lock Compact Hand 2.0/2.4**

For mechanical insertion use the corresponding torque limiting attachment.

The torque limiter prevents over-tightening and ensures that the locking screws are securely locked into the plate.

Use manual locking to perform the final locking step for 2.0 mm and 2.4 mm locking screws. Mechanical insertion is not recommended.

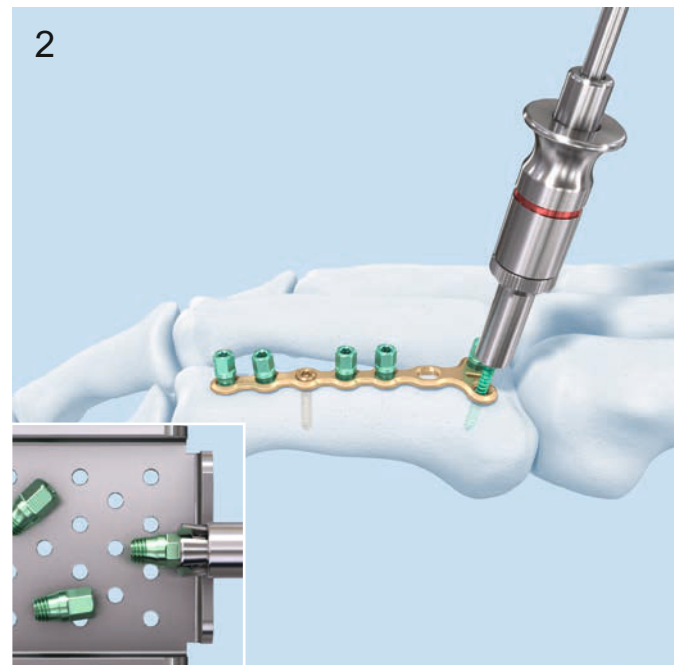

## Implant Removal

To remove the plate, first unlock all screws then definitely remove them in a second step. If the screws are not unlocked before removal the plate may rotate while the last screw is being removed and cause soft tissue damage.





## Additional Information

### Pick-up screws with Stardrive recess without holding sleeve

Select the screw and position the corresponding screwdriver perpendicular to the screw.

Pick-up the screw by applying slight axial pressure.

Make sure that the screwdriver remains perpendicular during screw extraction.

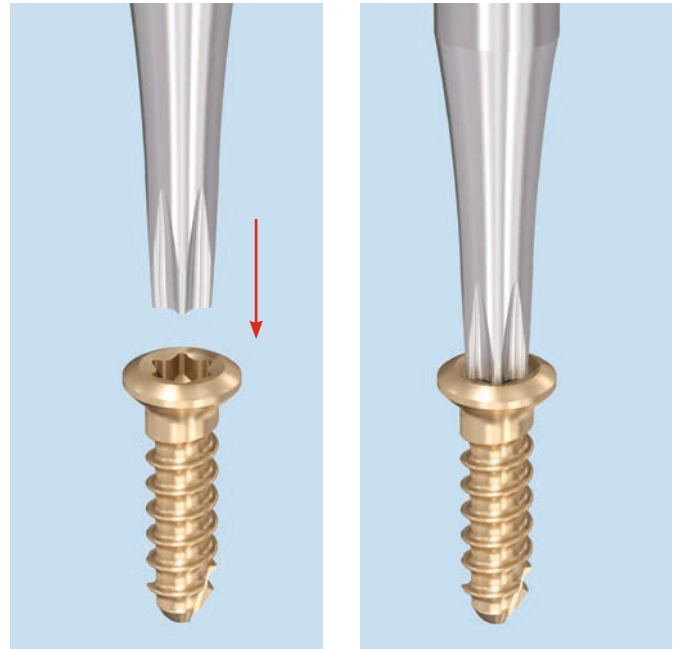

### Pick-up screws with holding sleeve

All screws can also be picked-up with help of the corresponding holding sleeves.

Slide the holding sleeve onto the screwdriver, until it clicks into place. With the holding sleeve jaws open, mount the appropriate screw onto the screwdriver, then push the holding sleeve until it secures the screw.

**Note:** The holding sleeve covers the head of the screw.

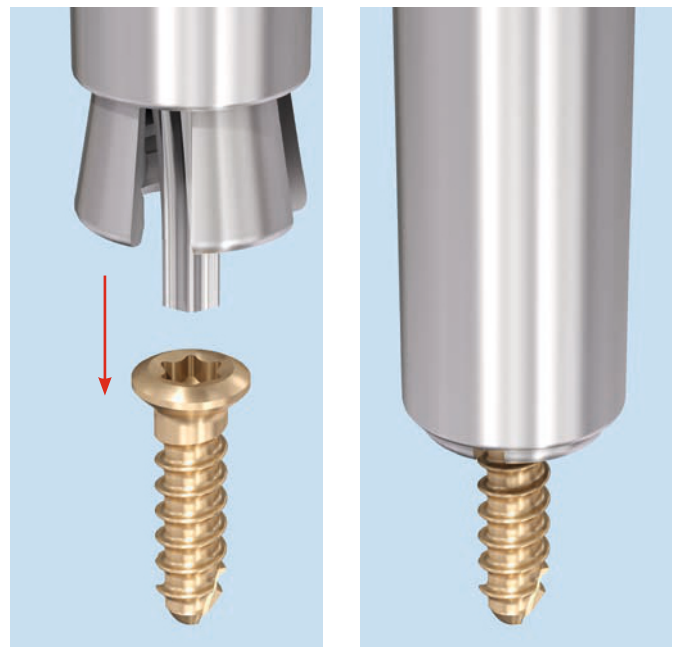

## Adaptable Locking Plates for Various Indications

The modular Wise-Lock Hand & Foot System offers a wide range of anatomical and adaptable plates. All Implants are available in Titanium.

Wise-Lock Hand & Foot Implants are intended for the following indications:

### 1.5mm Wise-Lock Hand System

- Fractures, osteotomies and arthrodesis of the phalanges and metacarpals
- Replantations and reconstructions of the phalanges and metacarpals

### 2.0mm Wise-Lock Hand System

- Fractures of the phalanges, metacarpals, wrist bones and distal radius (double-plate technique)
- Osteotomies and arthrodesis of the interphalangeal joints

### 2.4mm Wise-Lock Hand System

- Fractures of the metacarpals, wrist bones and distal radius (double-plate technique)
- Osteotomies and arthrodesis on the hand

### 2.7mm Wise-Lock Foot System

- Osteotomies and arthrodesis on the foot

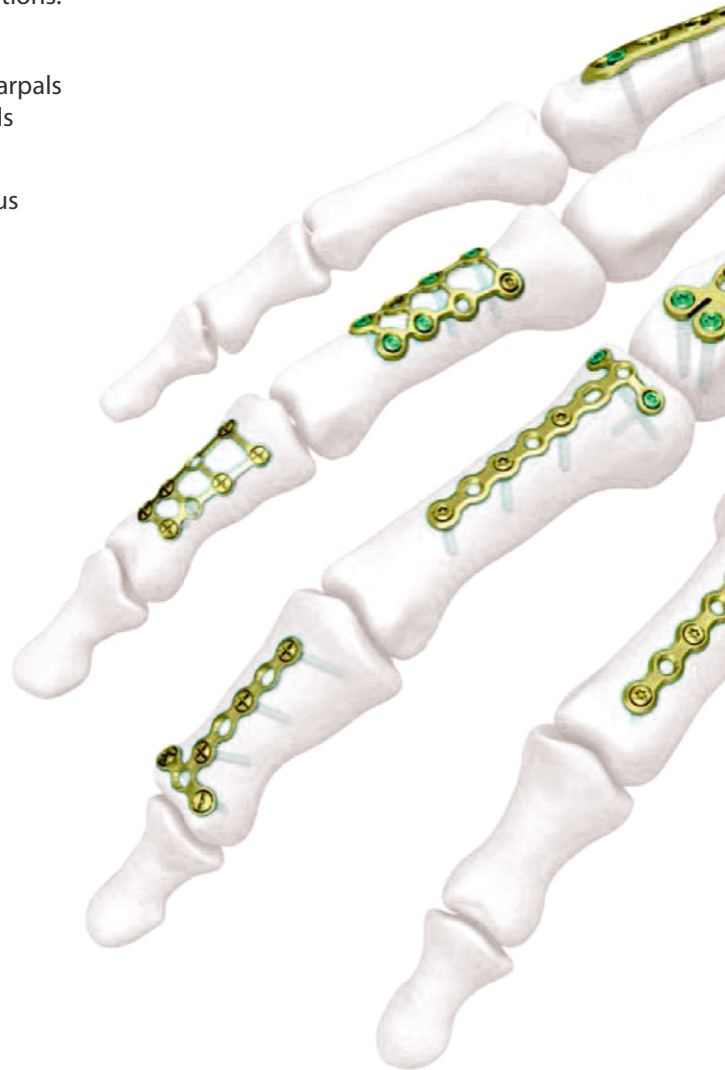

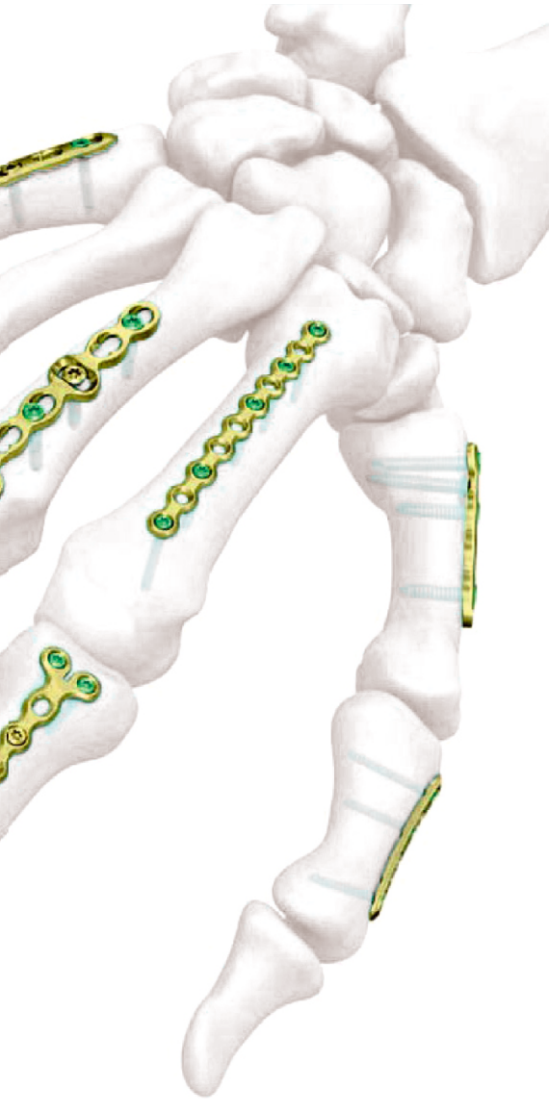

#### 4 Modules, 4 Dimensions:

- Adaptable plates for different indications
- Complete range of implants

1.5mm Wise-Lock  
2.0mm Wise-Lock  
2.4mm Wise-Lock  
2.7mm Wise-Lock

- Broad range of locking and Wise Lock plates to address various fracture patterns
- The use of locking screws allows creating a fixed-angle construct, which is particularly advantageous in osteopenic bone or in fractures near the joint

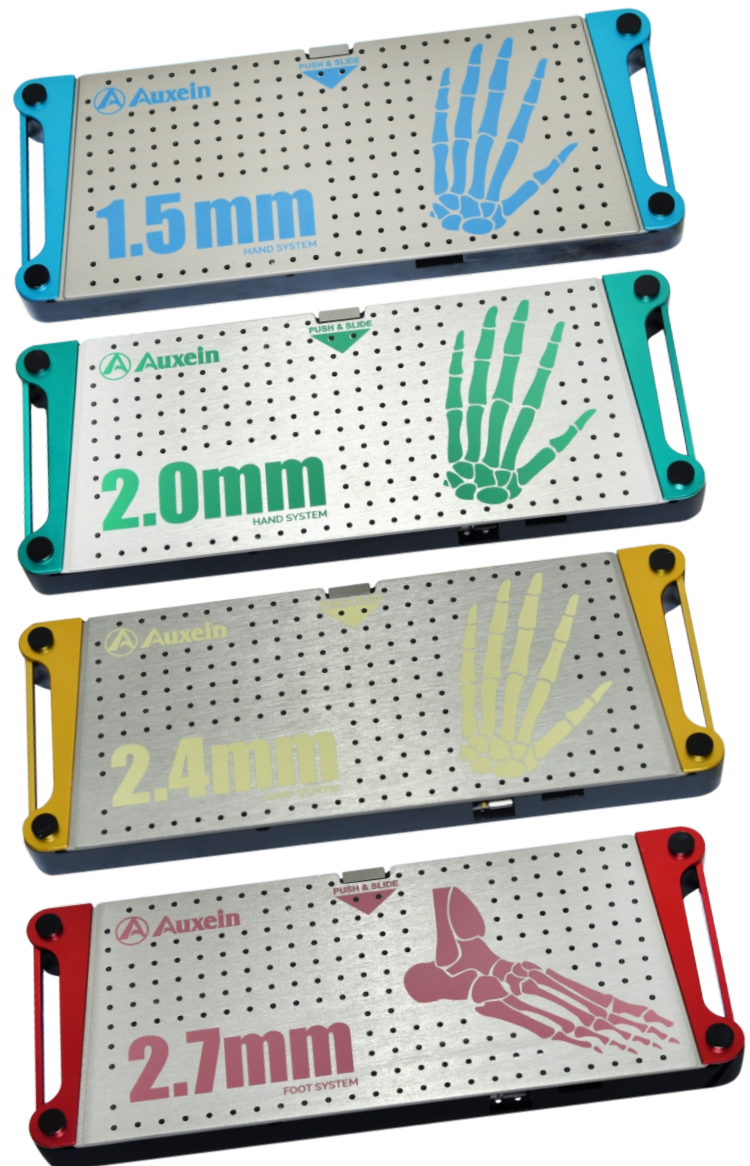

**1.5mm Wise-Lock Plate, Straight**

Code	Holes
<b>TI-554.04</b>	4
<b>TI-554.06</b>	6

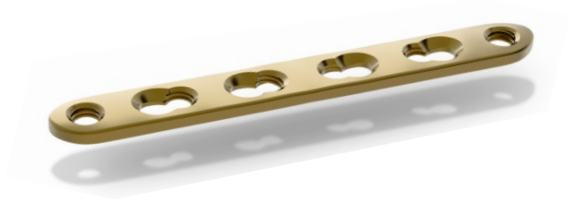
**1.5mm Wise-Lock Adaption Plate, Straight**

Code	Holes
<b>TI-555.06</b>	6
<b>TI-555.12</b>	12

**1.5mm Wise-Lock Adaption T-Plate**

Code	Holes
<b>TI-556.08.03</b>	Shaft 8, Head 3
<b>TI-556.08.04</b>	Shaft 8, Head 4

**1.5mm Wise-Lock Strut Plate**

Code	Holes
<b>TI-823.00R</b>	8
<b>TI-823.00L</b>	8

**1.5mm Wise-Lock Adaption Y-Plate**

Code	Holes
<b>TI-558.08</b>	Shaft 8, Head 3

**1.5mm Wise-Lock Condylar Plate**

Code	Holes
<b>TI-559.06</b>	Shaft 6, Head 2
<b>TI-559.08</b>	Shaft 8, Head 2



**1.5mm Cortical Screw, Self-Tapping, (Star Head)**

Code	Length
<b>TI-1281.06</b>	6mm
<b>TI-1281.07</b>	7mm
<b>TI-1281.08</b>	8mm
<b>TI-1281.09</b>	9mm
<b>TI-1281.10</b>	10mm
<b>TI-1281.11</b>	11mm
<b>TI-1281.12</b>	12mm
<b>TI-1281.13</b>	13mm
<b>TI-1281.14</b>	14mm
<b>TI-1281.15</b>	15mm
<b>TI-1281.16</b>	16mm
<b>TI-1281.18</b>	18mm
<b>TI-1281.20</b>	20mm
<b>TI-1281.22</b>	22mm
<b>TI-1281.24</b>	24mm

**1.5mm Wise-Lock Screw, Self-Tapping, (Star Head)**

Code	Length
<b>TI-1130.06</b>	6mm
<b>TI-1130.07</b>	7mm
<b>TI-1130.08</b>	8mm
<b>TI-1130.09</b>	9mm
<b>TI-1130.10</b>	10mm
<b>TI-1130.11</b>	11mm
<b>TI-1130.12</b>	12mm
<b>TI-1130.13</b>	13mm
<b>TI-1130.14</b>	14mm
<b>TI-1130.15</b>	15mm
<b>TI-1130.16</b>	16mm
<b>TI-1130.18</b>	18mm
<b>TI-1130.20</b>	20mm
<b>TI-1130.22</b>	22mm
<b>TI-1130.24</b>	24mm

**1.8mm Buttress Screw, (Star Head)**

Code	Length
<b>TI-1103.112</b>	12mm
<b>TI-1103.114</b>	14mm
<b>TI-1103.116</b>	16mm
<b>TI-1103.118</b>	18mm



**1135-01** Double Drill Guide Ø1.5/1.1mm



**1135-02** Wise-Lock Drill Sleeve 1.5mm For Drill Bit Ø1.1mm



**1135-03** Bending Pin With Thread For 1.5mm Wise-Lock Plates

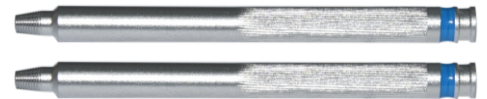

**1135-04** Drill Bit Quick Coupling Ø1.1mm x Length 75/61mm, 2-Flute



**1135-05** Drill Bit Quick Coupling Ø1.5mm x Length 65/50mm, 2-Flute



**1135-06** Countersink For 1.5mm Screws



**1135-07** Screwdriver Shaft, T4 for 1.5mm Screws



**1135-08** Screw Holding Sleeve for 1.5mm Cortical Screws



**1135-09** Screw Holding Sleeve for 1.5mm Wise-Lock Screws



**1138-08** Container with Tray and Lid For 1.5mm Implant & Instrument Set



**2.0mm Wise-Lock Plate, Straight**

Code	Holes
<b>TI-505.204</b>	4
<b>TI-505.205</b>	5
<b>TI-505.206</b>	6
<b>TI-505.207</b>	7
<b>TI-505.208</b>	8
<b>TI-505.210</b>	10



**2.0mm Adaption Plate, Straight**

Code	Holes
<b>TI-821.212</b>	12



**2.0mm Wise-Lock Adaption Plate, Straight**

Code	Holes
<b>TI-555.212</b>	12



**2.0mm Wise-Lock Condylar Plate**

Code	Holes
<b>TI-559.204</b>	Shaft 4, Head 2
<b>TI-559.205</b>	Shaft 5, Head 2
<b>TI-559.206</b>	Shaft 6, Head 2
<b>TI-559.207</b>	Shaft 7, Head 2



**2.0mm Wise-Lock Rotation Correction Plate**

Code	Holes
<b>TI-989C.204</b>	Shaft 4, Head 2
<b>TI-989C.205</b>	Shaft 5, Head 2





**2.0mm Wise-Lock T-Plate**

Code	Holes
<b>TI-556.204</b>	Shaft 4, Head 3
<b>TI-556.205</b>	Shaft 5, Head 3
<b>TI-556.206</b>	Shaft 6, Head 3
<b>TI-556.207</b>	Shaft 7, Head 3

**2.0mm Wise-Lock T-Adaption Plate**

Code	Holes
<b>TI-555.207T</b>	Shaft 7, Head 2

**2.0mm Wise-Lock Y-Adaption Plate**

Code	Holes
<b>TI-555.207Y</b>	Shaft 7, Head 3



**2.0mm Wise-Lock Mini Condylar Plate**

Code	Holes	Type
<b>TI-515.07L</b>	7	Left
<b>TI-515.07R</b>	7	Right

**2.0mm Wise-Lock Mini H-Plate**

Code	Holes	External Dimensions
<b>TI-814.04</b>	4	11x12mm

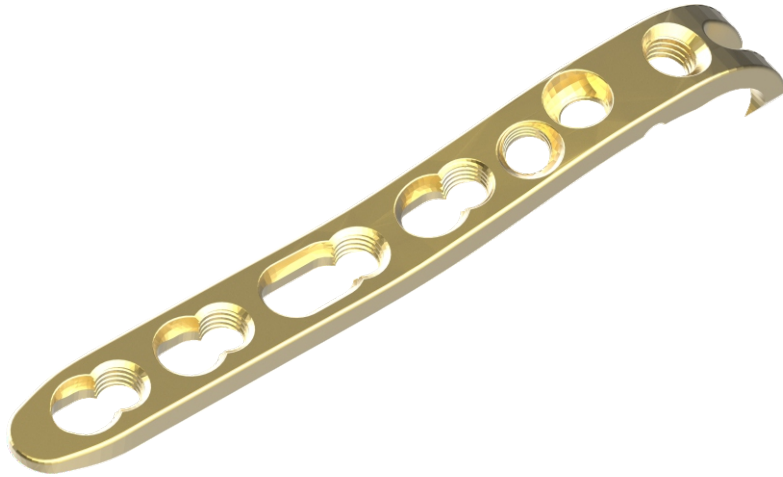



### 2.0mm Wise-Lock Distal Ulna Hook Plate

Titanium	Stainless Steel	Holes
<b>10-063-07TI</b>	<b>10-063-07SS</b>	7

**2.0mm Cortical Screw, Self-Tapping, (Star Head)**

Code	Length
TI-102.206	6mm
TI-102.207	7mm
TI-102.208	8mm
TI-102.209	9mm
TI-102.210	10mm
TI-102.211	11mm
TI-102.212	12mm
TI-102.213	13mm
TI-102.214	14mm
TI-102.215	15mm
TI-102.216	16mm
TI-102.218	18mm
TI-102.220	20mm
TI-102.222	22mm
TI-102.224	24mm
TI-102.226	26mm
TI-102.228	28mm
TI-102.230	30mm
TI-102.232	32mm
TI-102.234	34mm
TI-102.236	36mm
TI-102.238	38mm
TI-102.240	40mm



**2.0mm Wise-Lock Screw, Self-Tapping, (Star Head)**

Code	Length
TI-1131.06	6mm
TI-1131.07	7mm
TI-1131.08	8mm
TI-1131.09	9mm
TI-1131.10	10mm
TI-1131.11	11mm
TI-1131.12	12mm
TI-1131.13	13mm
TI-1131.14	14mm
TI-1131.15	15mm
TI-1131.16	16mm
TI-1131.18	18mm
TI-1131.20	20mm
TI-1131.22	22mm
TI-1131.24	24mm
TI-1131.26	26mm
TI-1131.28	28mm
TI-1131.30	30mm
TI-1131.32	32mm
TI-1131.34	34mm
TI-1131.36	36mm
TI-1131.38	38mm
TI-1131.40	40mm



**1136-01** Self-Centering Double Drill Guide  $\varnothing 2.0/1.5\text{mm}$



**1136-02** Wise-Lock Drill Sleeve 2.0mm, For Drill Bit,  $\varnothing 1.5\text{mm}$



**1136-03** Bending Pin with thread For 2.0mm Wise-Lock Plates

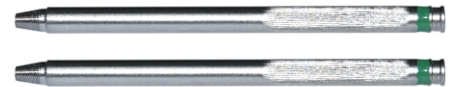

**1136-04** Drill Bit Quick Coupling  $\varnothing 1.5\text{mm}$  x Length 96/82mm, 2-Flute



**1136-05** Drill Bit Quick Coupling  $\varnothing 2.0\text{mm}$  x Length 67/55mm, 2-Flute



**1136-06** Countersink For 2.0/2.4/2.7mm Screws



**1136-10** Screwdriver Shaft, T6 for 2.0mm Screws



**1136-08** Screw Holding Sleeve For 2.0mm Cortical Screws



**1136-09** Screw Holding Sleeve For 2.0mm Wise-Lock Screws



**1138-09** Container with Tray and Lid For 2.0mm Implant & Instrument Set



**2.4mm Wise-Lock Plate, Straight**

Code	Holes
<b>TI-505.304</b>	4
<b>TI-505.305</b>	5
<b>TI-505.306</b>	6
<b>TI-505.307</b>	7
<b>TI-505.308</b>	8
<b>TI-505.310</b>	10



**2.4mm Adaption Plate, Straight**

Code	Holes
<b>TI-821.312</b>	12



**2.4mm Wise-Lock Adaption Plate, Straight**

Code	Holes
<b>TI-555.312</b>	12



**2.4mm Wise-Lock Condylar Plate**

Code	Holes
<b>TI-559.304</b>	Shaft 4, Head 2
<b>TI-559.305</b>	Shaft 5, Head 2
<b>TI-559.306</b>	Shaft 6, Head 2
<b>TI-559.307</b>	Shaft 7, Head 2



**2.4mm Wise-Lock T-Adaption Plate**

Code	Holes
<b>TI-555.307T</b>	Shaft 7, Head 2

**2.4mm Wise-Lock T-Plate**

Code	Holes
<b>TI-556.304</b>	Shaft 4, Head 3
<b>TI-556.305</b>	Shaft 5, Head 3
<b>TI-556.306</b>	Shaft 6, Head 3
<b>TI-556.307</b>	Shaft 7, Head 3

**2.4mm Wise-Lock Y-Adaption Plate**

Code	Holes
<b>TI-555.304Y</b>	Shaft 4, Head 3
<b>TI-555.305Y</b>	Shaft 5, Head 3
<b>TI-555.306Y</b>	Shaft 6, Head 3
<b>TI-555.307Y</b>	Shaft 7, Head 3



## 2.4mm Cortical Screw, Self-Tapping, (Star Head)



Code	Length
TI-1144.06	6mm
TI-1144.07	7mm
TI-1144.08	8mm
TI-1144.09	9mm
TI-1144.10	10mm
TI-1144.11	11mm
TI-1144.12	12mm
TI-1144.13	13mm
TI-1144.14	14mm
TI-1144.16	16mm
TI-1144.18	18mm
TI-1144.20	20mm
TI-1144.22	22mm
TI-1144.24	24mm
TI-1144.26	26mm
TI-1144.28	28mm
TI-1144.30	30mm
TI-1144.32	32mm
TI-1144.34	34mm
TI-1144.36	36mm
TI-1144.38	38mm
TI-1144.40	40mm

## 2.4mm Wise-Lock Screw, Self-Tapping, (Star Head)



Code	Length
TI-1145.06	6mm
TI-1145.07	7mm
TI-1145.08	8mm
TI-1145.09	9mm
TI-1145.10	10mm
TI-1145.11	11mm
TI-1145.12	12mm
TI-1145.13	13mm
TI-1145.14	14mm
TI-1145.16	16mm
TI-1145.18	18mm
TI-1145.20	20mm
TI-1145.22	22mm
TI-1145.24	24mm
TI-1145.26	26mm
TI-1145.28	28mm
TI-1145.30	30mm
TI-1145.32	32mm
TI-1145.34	34mm
TI-1145.36	36mm
TI-1145.38	38mm
TI-1145.40	40mm
TI-1145.42	42mm
TI-1145.44	44mm
TI-1145.46	46mm
TI-1145.48	48mm
TI-1145.50	50mm



**1137-01** Self-Centering Double Drill Guide  $\varnothing 2.4/1.8\text{mm}$



**1137-02** Wise-Lock Drill Sleeve 2.4mm For Drill Bit  $\varnothing 1.8\text{mm}$



**1136-06** Countersink For 2.0/2.4/2.7mm Screws



**1137-03** Bending Pin With Thread For 2.4mm/2.7mm Wise-Lock Plates

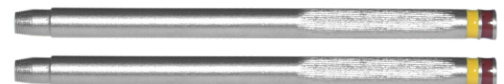

**1137-04** Drill Bit Quick Coupling  $\varnothing 1.8\text{mm}$  x Length 110/82mm, 2-Flute



**1137-05** Drill Bit Quick Coupling  $\varnothing 2.4\text{mm}$  x Length 100/73mm, 2-Flute



**1137-07** Screwdriver Shaft, T8 For 2.4mm/2.7mm Screws



**1137-08** Holding Sleeve For 2.4mm Cortical Screws



**1137-09** Holding Sleeve For 2.4/2.7mm Wise-Lock Screws



**1138-10** Container with Tray and Lid For 2.4mm Implant & Instrument Set



**2.7mm Wise-Lock Plate, Straight**

Code	Holes
<b>TI-505.404</b>	4
<b>TI-505.405</b>	5
<b>TI-505.406</b>	6
<b>TI-505.407</b>	7
<b>TI-505.408</b>	8
<b>TI-505.410</b>	10

**2.7mm Wise-Lock Condylar Plate**

Code	Holes
<b>TI-559.404</b>	Shaft 4, Head 2
<b>TI-559.405</b>	Shaft 5, Head 2
<b>TI-559.406</b>	Shaft 6, Head 2
<b>TI-559.407</b>	Shaft 7, Head 2

**2.7mm Wise-Lock T-Plate**

Code	Holes
<b>TI-556.403</b>	Shaft 3, Head 2
<b>TI-556.404</b>	Shaft 4, Head 2



**2.7mm Wise-Lock L-Plate**

Code	Holes	Type
<b>TI-813.403L</b>	Shaft 3, Head 2	Left
<b>TI-813.403R</b>	Shaft 3, Head 2	Right
<b>TI-813.404L</b>	Shaft 4, Head 2	Left
<b>TI-813.404R</b>	Shaft 4, Head 2	Right

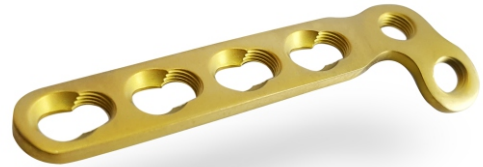

**2.7mm Wise-Lock L-Plate, Oblique**

Code	Holes	Type
<b>TI-1133.03L</b>	Shaft 3, Head 2	Left
<b>TI-1133.03R</b>	Shaft 3, Head 2	Right
<b>TI-1133.04L</b>	Shaft 4, Head 2	Left
<b>TI-1133.04R</b>	Shaft 4, Head 2	Right

**2.7mm Wise-Lock Mini Condylar Plate**

Code	Holes	Type
<b>TI-516.307L</b>	7	Left
<b>TI-516.307R</b>	7	Right

**2.7mm Wise-Lock Straight Plate**

Code	Holes
<b>TI-1134.02</b>	2

**2.4/2.7mm Wise-Lock X-Plate**

Code	Holes	Length
<b>TI-812.301</b>	4	22x14mm
<b>TI-812.302</b>	4	24x18mm
<b>TI-812.303</b>	4	30x20mm
<b>TI-812.304</b>	4	36x20mm



## 2.7mm Cortical Screw, Self-Tapping, (Star Head)



Code	Length
TI-1242.06	6
TI-1242.08	8
TI-1242.10	10
TI-1242.12	12
TI-1242.14	14
TI-1242.16	16
TI-1242.18	18
TI-1242.20	20
TI-1242.22	22
TI-1242.24	24
TI-1242.26	26
TI-1242.28	28
TI-1242.30	30
TI-1242.32	32
TI-1242.34	34
TI-1242.36	36
TI-1242.38	38
TI-1242.40	40
TI-1242.42	42
TI-1242.44	44
TI-1242.46	46
TI-1242.48	48
TI-1242.50	50

## 2.7mm Wise-Lock Screw, Self-Tapping, (Star Head)



Code	Length
TI-1241.06	6mm
TI-1241.07	7mm
TI-1241.08	8mm
TI-1241.09	9mm
TI-1241.10	10mm
TI-1241.12	12mm
TI-1241.14	14mm
TI-1241.16	16mm
TI-1241.18	18mm
TI-1241.20	20mm
TI-1241.22	22mm
TI-1241.24	24mm
TI-1241.26	26mm
TI-1241.28	28mm
TI-1241.30	30mm
TI-1241.32	32mm
TI-1241.34	34mm
TI-1241.36	36mm
TI-1241.38	38mm
TI-1241.40	40mm
TI-1241.42	42mm
TI-1241.44	44mm
TI-1241.46	46mm
TI-1241.48	48mm
TI-1241.50	50mm
TI-1241.52	52mm
TI-1241.54	54mm
TI-1241.56	56mm
TI-1241.58	58mm
TI-1241.60	60mm

**1137-07** Screwdriver Shaft, T8 For 2.4mm/2.7mm Screws



**1137-03** Bending Pin With Thread For 2.4mm/2.7mm Wise-Lock Plates

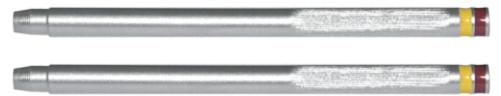

**1137-09** Holding Sleeve For 2.4/2.7mm Wise-Lock Screws



**1136-06** Countersink For 2.0/2.4/2.7mm Screws



**1138-01** Self-Centering Double Drill Guide  $\varnothing 2.7/2.0\text{mm}$



**1138-02** Wise-Lock Drill Sleeve 2.7mm For Drill Bits  $\varnothing 2.0\text{mm}$



**1138-04** Drill Bit Quick Coupling Ø2.0mm x Length 110mm, 2-Flute



**1138-05** Drill Bit Quick Coupling Ø2.7mm x Length 102mm, 2-Flute



**1138-41** Holding Sleeve For 2.7mm Cortical Screws



**1138-11** Container with Tray and Lid For 2.7mm Implant & Instrument Set



**1138-08** Container with Tray and Lid For 1.5mm Implant & Instrument Set

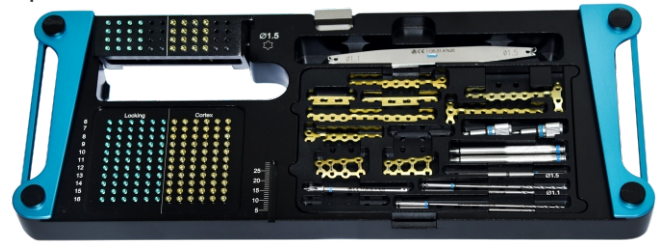

**1138-09** Container with Tray and Lid For 2.0mm Implant & Instrument Set

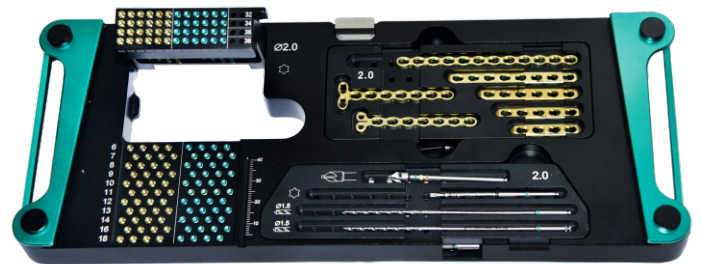

**1138-10** Container with Tray and Lid For 2.4mm Implant & Instrument Set

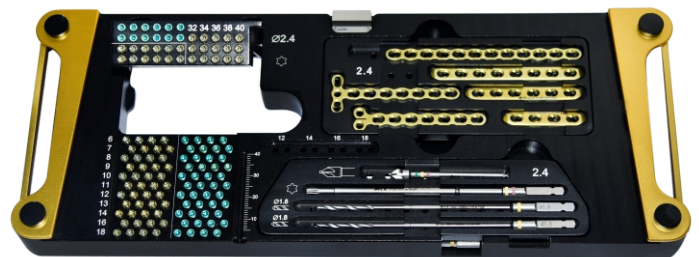

**1138-11** Container with Tray and Lid For 2.7mm Implant & Instrument Set

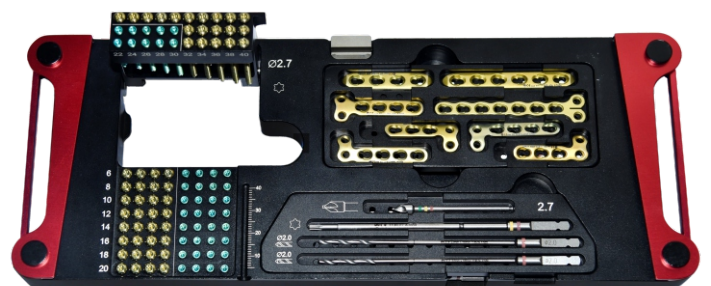



1138-08 Container with Tray and Lid For 1.5mm Implant & Instrument Set

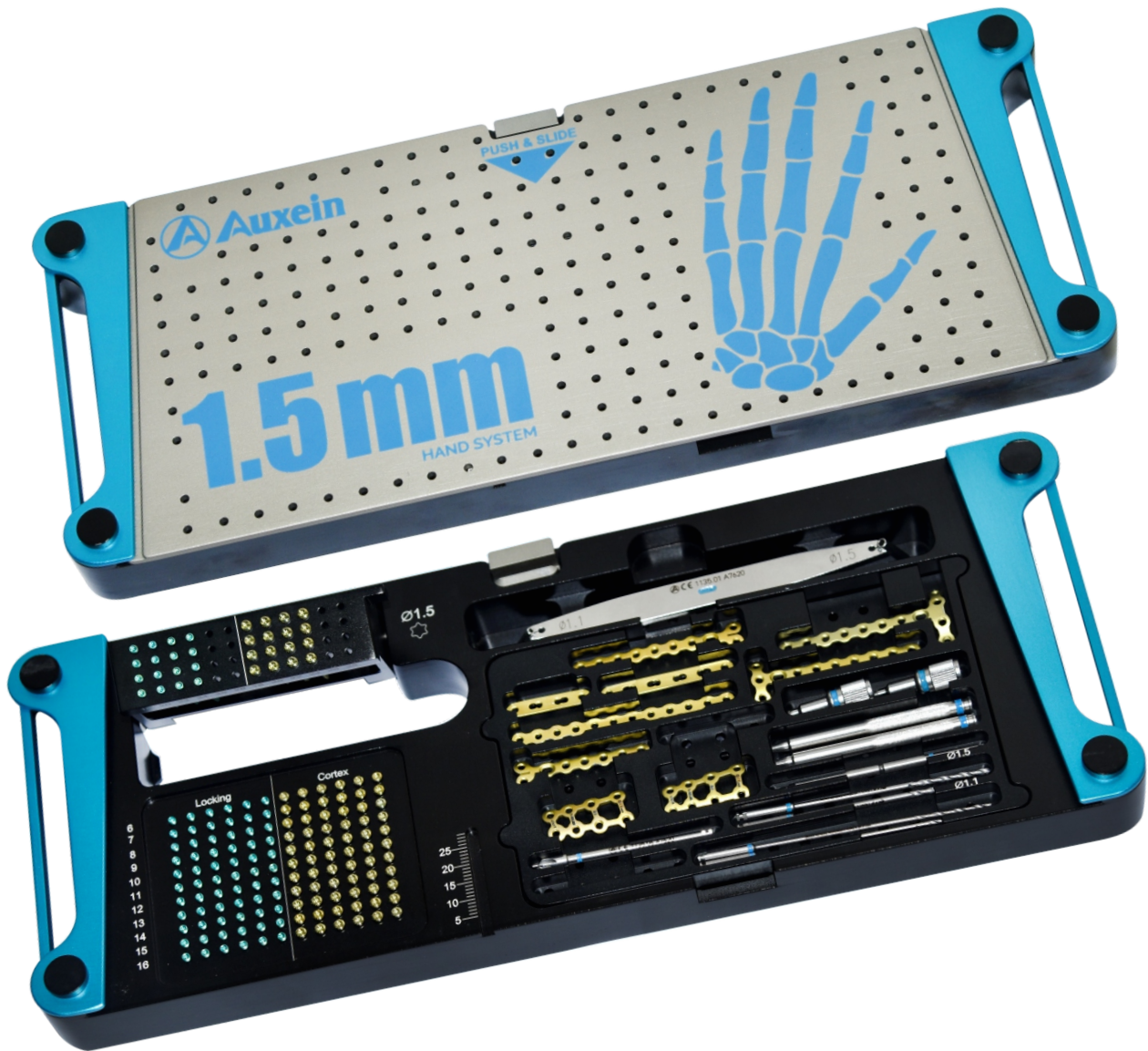

Instruments for 1.5mm Wise-Lock Modular Hand System

Code	Items	Qty
1135-01	Double Drill Guide Ø1.5/1.1mm	1
1135-02	Wise-Lock Drill Sleeve 1.5mm For Drill Bit Ø1.1mm	2
1135-03	Bending Pin With Thread For 1.5mm Wise-Lock Plates	2
1135-04	Drill Bit Quick Coupling Ø1.1mm x Length 75/61mm, 2-Flute	2
1135-05	Drill Bit Quick Coupling Ø1.5mm x Length 65/50mm, 2-Flute	2
1135-06	Countersink For 1.5mm Screws	1
1135-07	Screwdriver Shaft, T4 for 1.5mm Screws	1
1135-08	Screw Holding Sleeve for 1.5mm Cortical Screws	1
1135-09	Screw Holding Sleeve for 1.5mm Wise-Lock Screws	1
1138-08	Container with Tray and Lid For 1.5mm Implant & Instrument Set	1

**1138-08 Container with Tray and Lid For 1.5mm Implant & Instrument Set**

Implants For 1.5mm Wise-lock Modular Hand System			
Code	Items	Qty	
Plates	<b>TI-554.04</b>	1.5mm Wise-Lock Plate, Straight, 4 Holes	1
	<b>TI-554.06</b>	1.5mm Wise-Lock Plate, Straight, 6 Holes	1
	<b>TI-555.12</b>	1.5mm Wise-Lock Adaption Plate, Straight, 12 Holes	1
	<b>TI-556.08.03</b>	1.5mm Wise-Lock Adaption T-Plate, (3 Head Holes), 8 Holes	1
	<b>TI-556.08.04</b>	1.5mm Wise-Lock Adaption T-Plate, (4 Head Holes), 8 Holes	1
	<b>TI-823.00L</b>	1.5mm Wise-Lock Strut Plate, 8 Holes - Left	1
	<b>TI-823.00R</b>	1.5mm Wise-Lock Strut Plate, 8 Holes - Right	1
	<b>TI-559.06</b>	1.5mm Wise-Lock Condylar Plate, (2 Head Holes), 6 Holes	1
<b>TI-559.08</b>	1.5mm Wise-Lock Condylar Plate, (2 Head Holes), 8 Holes	1	
Screws	<b>TI-1281.06</b>	1.5mm Cortical Screws, Self-Tapping, (Star Head), Length 6mm, Titanium	6
	<b>TI-1281.07</b>	1.5mm Cortical Screws, Self-Tapping, (Star Head), Length 7mm, Titanium	6
	<b>TI-1281.08</b>	1.5mm Cortical Screws, Self-Tapping, (Star Head), Length 8mm, Titanium	6
	<b>TI-1281.09</b>	1.5mm Cortical Screws, Self-Tapping, (Star Head), Length 9mm, Titanium	6
	<b>TI-1281.10</b>	1.5mm Cortical Screws, Self-Tapping, (Star Head), Length 10mm, Titanium	6
	<b>TI-1281.11</b>	1.5mm Cortical Screws, Self-Tapping, (Star Head), Length 11mm, Titanium	6
	<b>TI-1281.12</b>	1.5mm Cortical Screws, Self-Tapping, (Star Head), Length 12mm, Titanium	6
	<b>TI-1281.13</b>	1.5mm Cortical Screws, Self-Tapping, (Star Head), Length 13mm, Titanium	6
	<b>TI-1281.14</b>	1.5mm Cortical Screws, Self-Tapping, (Star Head), Length 14mm, Titanium	6
	<b>TI-1281.16</b>	1.5mm Cortical Screws, Self-Tapping, (Star Head), Length 16mm, Titanium	6
	<b>TI-1281.18</b>	1.5mm Cortical Screws, Self-Tapping, (Star Head), Length 18mm, Titanium	4
	<b>TI-1281.20</b>	1.5mm Cortical Screws, Self-Tapping, (Star Head), Length 20mm, Titanium	4
	<b>TI-1281.22</b>	1.5mm Cortical Screws, Self-Tapping, (Star Head), Length 22mm, Titanium	4
	<b>TI-1281.24</b>	1.5mm Cortical Screws, Self-Tapping, (Star Head), Length 24mm, Titanium	4
	<b>TI-1281.26</b>	1.5mm Cortical Screws, Self-Tapping, (Star Head), Length 26mm, Titanium	4
	<b>TI-1281.28</b>	1.5mm Cortical Screws, Self-Tapping, (Star Head), Length 28mm, Titanium	4
Screws	<b>TI-1130.06</b>	1.5mm Wise-Lock Screws, Self-Tapping, (Star Head), Length 6mm, Titanium	6
	<b>TI-1130.07</b>	1.5mm Wise-Lock Screws, Self-Tapping, (Star Head), Length 7mm, Titanium	6
	<b>TI-1130.08</b>	1.5mm Wise-Lock Screws, Self-Tapping, (Star Head), Length 8mm, Titanium	6
	<b>TI-1130.09</b>	1.5mm Wise-Lock Screws, Self-Tapping, (Star Head), Length 9mm, Titanium	6
	<b>TI-1130.10</b>	1.5mm Wise-Lock Screws, Self-Tapping, (Star Head), Length 10mm, Titanium	6
	<b>TI-1130.11</b>	1.5mm Wise-Lock Screws, Self-Tapping, (Star Head), Length 11mm, Titanium	6
	<b>TI-1130.12</b>	1.5mm Wise-Lock Screws, Self-Tapping, (Star Head), Length 12mm, Titanium	6
	<b>TI-1130.13</b>	1.5mm Wise-Lock Screws, Self-Tapping, (Star Head), Length 13mm, Titanium	6
	<b>TI-1130.14</b>	1.5mm Wise-Lock Screws, Self-Tapping, (Star Head), Length 14mm, Titanium	6
	<b>TI-1130.16</b>	1.5mm Wise-Lock Screws, Self-Tapping, (Star Head), Length 16mm, Titanium	6
	<b>TI-1130.18</b>	1.5mm Wise-Lock Screws, Self-Tapping, (Star Head), Length 18mm, Titanium	4
	<b>TI-1130.20</b>	1.5mm Wise-Lock Screws, Self-Tapping, (Star Head), Length 20mm, Titanium	4
	<b>TI-1130.22</b>	1.5mm Wise-Lock Screws, Self-Tapping, (Star Head), Length 22mm, Titanium	4
	<b>TI-1130.24</b>	1.5mm Wise-Lock Screws, Self-Tapping, (Star Head), Length 24mm, Titanium	4
	<b>TI-1130.26</b>	1.5mm Wise-Lock Screws, Self-Tapping, (Star Head), Length 26mm, Titanium	4
	<b>TI-1130.28</b>	1.5mm Wise-Lock Screws, Self-Tapping, (Star Head), Length 28mm, Titanium	4

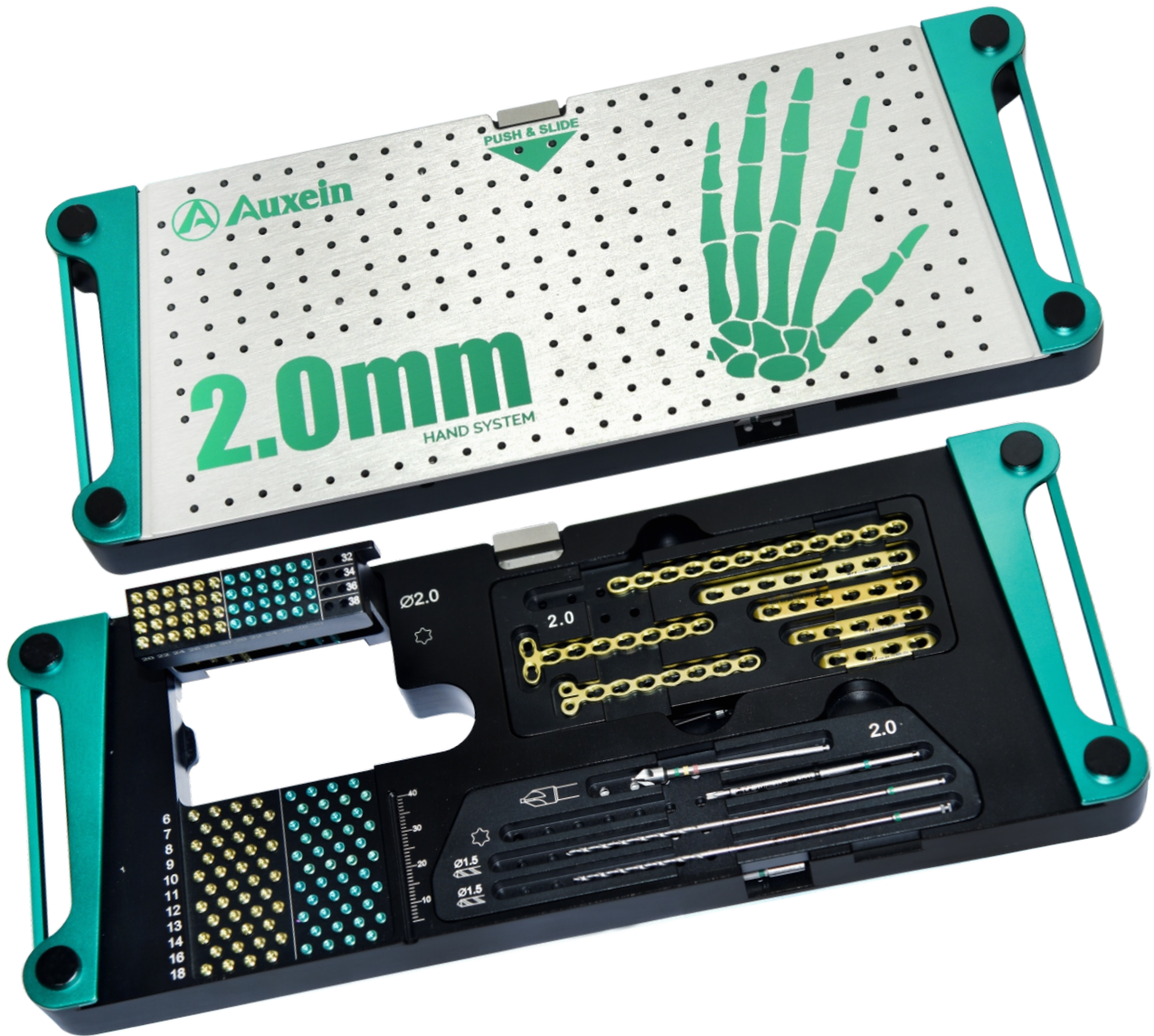
**1138-09** Container with Tray and Lid For 2.0mm Implant & Instrument Set

**Instruments for 2.0mm Wise-Lock Modular Hand System**

Code	Items	Qty
<b>1136-01</b>	Self-Centering Double Drill Guide Ø2.0/1.5mm	1
<b>1136-02</b>	Wise-Lock Drill Sleeve 2.0mm, For Drill Bit, Ø1.5mm	2
<b>1136-03</b>	Bending Pin with thread For 2.0mm Wise-Lock Plates	2
<b>1136-04</b>	Drill Bit Quick Coupling Ø1.5mm x Length 96/82mm, 2-Flute	2
<b>1136-05</b>	Drill Bit Quick Coupling Ø2.0mm x Length 67/55mm, 2-Flute	2
<b>1136-06</b>	Countersink For 2.0/2.4/2.7mm Screws	1
<b>1136-10</b>	Screwdriver Shaft, T6 for 2.0mm Screws	1
<b>1136-08</b>	Screw Holding Sleeve For 2.0mm Cortical Screws	1
<b>1136-09</b>	Screw Holding Sleeve For 2.0mm Wise-Lock Screws	1
<b>1138-09</b>	Container with Tray and Lid For 2.0mm Implant & Instrument Set	1

**1138-09 Container with Tray and Lid For 2.0mm Implant & Instrument Set**

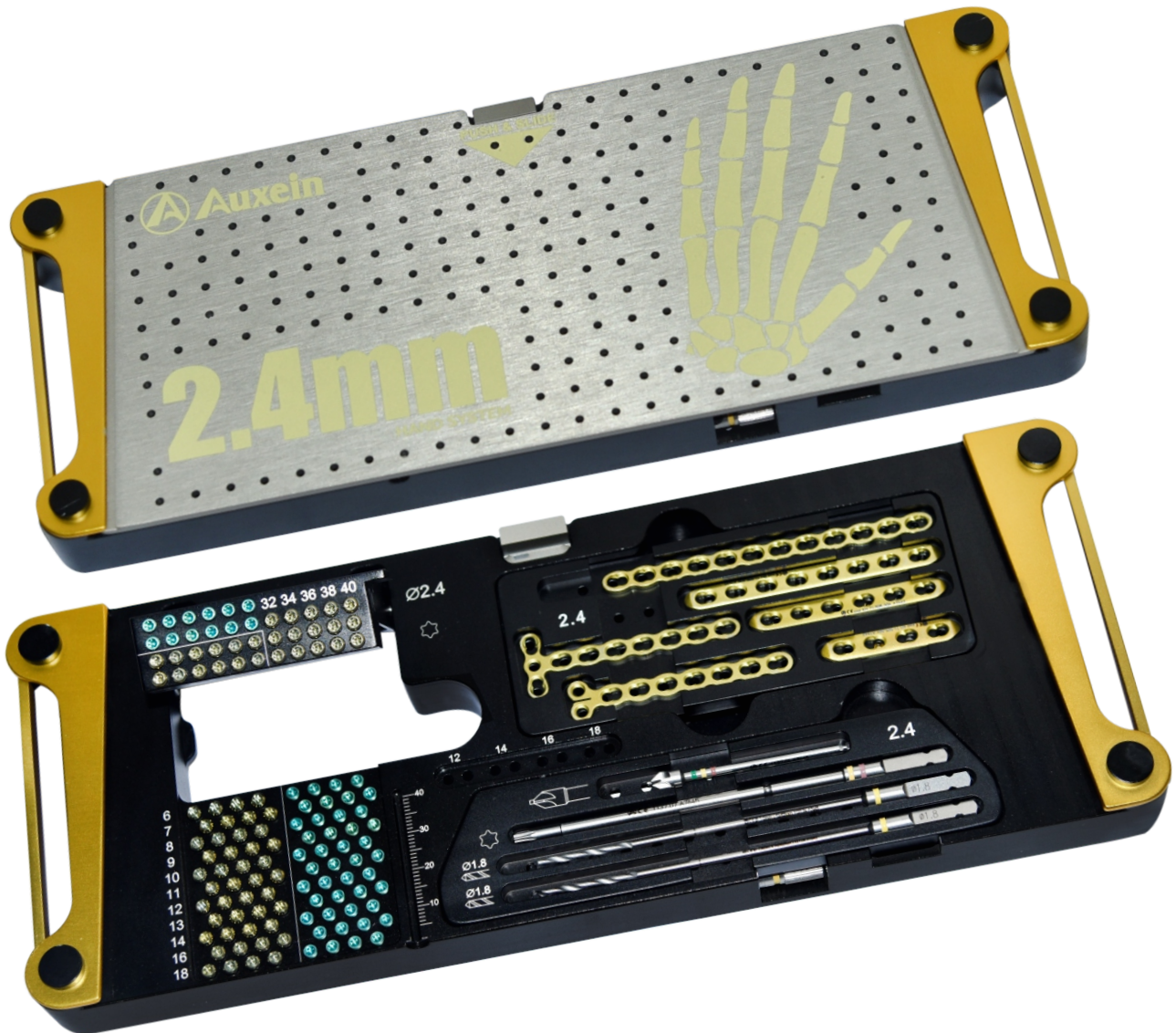
Implants For 2.0mm Wise-lock Modular Hand System			
	Code	Items	Qty
Plates	<b>TI-505.204</b>	2.0mm Wise-Lock Plate, Straight, 4 Holes	1
	<b>TI-505.205</b>	2.0mm Wise-Lock Plate, Straight, 5 Holes	1
	<b>TI-505.206</b>	2.0mm Wise-Lock Plate, Straight, 6 Holes	1
	<b>TI-505.208</b>	2.0mm Wise-Lock Plate, Straight, 8 Holes	1
	<b>TI-821.212</b>	2.0mm Adaption Plate, Straight, 12 Holes	1
	<b>TI-559.207</b>	2.0mm Wise-Lock Condylar Plate, (2 Head Holes), 7 Holes	1
	<b>TI-555.207T</b>	2.0mm Wise-Lock T-Adaption Plate, (2 Head Holes), 7 Holes	1
Screws	<b>TI-102.206</b>	2.0mm Cortical Screws, Self-Tapping, (Star Head), Length 6mm, Titanium	4
	<b>TI-102.207</b>	2.0mm Cortical Screws, Self-Tapping, (Star Head), Length 7mm, Titanium	4
	<b>TI-102.208</b>	2.0mm Cortical Screws, Self-Tapping, (Star Head), Length 8mm, Titanium	4
	<b>TI-102.209</b>	2.0mm Cortical Screws, Self-Tapping, (Star Head), Length 9mm, Titanium	4
	<b>TI-102.210</b>	2.0mm Cortical Screws, Self-Tapping, (Star Head), Length 10mm, Titanium	4
	<b>TI-102.211</b>	2.0mm Cortical Screws, Self-Tapping, (Star Head), Length 11mm, Titanium	4
	<b>TI-102.212</b>	2.0mm Cortical Screws, Self-Tapping, (Star Head), Length 12mm, Titanium	4
	<b>TI-102.213</b>	2.0mm Cortical Screws, Self-Tapping, (Star Head), Length 13mm, Titanium	4
	<b>TI-102.214</b>	2.0mm Cortical Screws, Self-Tapping, (Star Head), Length 14mm, Titanium	4
	<b>TI-102.216</b>	2.0mm Cortical Screws, Self-Tapping, (Star Head), Length 16mm, Titanium	4
	<b>TI-102.218</b>	2.0mm Cortical Screws, Self-Tapping, (Star Head), Length 18mm, Titanium	4
	<b>TI-102.220</b>	2.0mm Cortical Screws, Self-Tapping, (Star Head), Length 20mm, Titanium	4
	<b>TI-102.222</b>	2.0mm Cortical Screws, Self-Tapping, (Star Head), Length 22mm, Titanium	4
	<b>TI-102.224</b>	2.0mm Cortical Screws, Self-Tapping, (Star Head), Length 24mm, Titanium	4
	<b>TI-102.226</b>	2.0mm Cortical Screws, Self-Tapping, (Star Head), Length 26mm, Titanium	4
	<b>TI-102.228</b>	2.0mm Cortical Screws, Self-Tapping, (Star Head), Length 28mm, Titanium	4
	<b>TI-102.230</b>	2.0mm Cortical Screws, Self-Tapping, (Star Head), Length 30mm, Titanium	4
	<b>TI-102.232</b>	2.0mm Cortical Screws, Self-Tapping, (Star Head), Length 32mm, Titanium	2
	<b>TI-102.234</b>	2.0mm Cortical Screws, Self-Tapping, (Star Head), Length 34mm, Titanium	2
	<b>TI-102.236</b>	2.0mm Cortical Screws, Self-Tapping, (Star Head), Length 36mm, Titanium	2
<b>TI-102.238</b>	2.0mm Cortical Screws, Self-Tapping, (Star Head), Length 38mm, Titanium	2	
Screws	<b>TI-1131.06</b>	2.0mm Wise-Lock Screws, Self-Tapping, (Star Head), Length 6mm, Titanium	4
	<b>TI-1131.07</b>	2.0mm Wise-Lock Screws, Self-Tapping, (Star Head), Length 7mm, Titanium	4
	<b>TI-1131.08</b>	2.0mm Wise-Lock Screws, Self-Tapping, (Star Head), Length 8mm, Titanium	4
	<b>TI-1131.09</b>	2.0mm Wise-Lock Screws, Self-Tapping, (Star Head), Length 9mm, Titanium	4
	<b>TI-1131.10</b>	2.0mm Wise-Lock Screws, Self-Tapping, (Star Head), Length 10mm, Titanium	4
	<b>TI-1131.11</b>	2.0mm Wise-Lock Screws, Self-Tapping, (Star Head), Length 11mm, Titanium	4
	<b>TI-1131.12</b>	2.0mm Wise-Lock Screws, Self-Tapping, (Star Head), Length 12mm, Titanium	4
	<b>TI-1131.13</b>	2.0mm Wise-Lock Screws, Self-Tapping, (Star Head), Length 13mm, Titanium	4
	<b>TI-1131.14</b>	2.0mm Wise-Lock Screws, Self-Tapping, (Star Head), Length 14mm, Titanium	4
	<b>TI-1131.16</b>	2.0mm Wise-Lock Screws, Self-Tapping, (Star Head), Length 16mm, Titanium	4
	<b>TI-1131.18</b>	2.0mm Wise-Lock Screws, Self-Tapping, (Star Head), Length 18mm, Titanium	4
	<b>TI-1131.20</b>	2.0mm Wise-Lock Screws, Self-Tapping, (Star Head), Length 20mm, Titanium	4
	<b>TI-1131.22</b>	2.0mm Wise-Lock Screws, Self-Tapping, (Star Head), Length 22mm, Titanium	4
	<b>TI-1131.24</b>	2.0mm Wise-Lock Screws, Self-Tapping, (Star Head), Length 24mm, Titanium	4
	<b>TI-1131.26</b>	2.0mm Wise-Lock Screws, Self-Tapping, (Star Head), Length 26mm, Titanium	4
	<b>TI-1131.28</b>	2.0mm Wise-Lock Screws, Self-Tapping, (Star Head), Length 28mm, Titanium	4
	<b>TI-1131.30</b>	2.0mm Wise-Lock Screws, Self-Tapping, (Star Head), Length 30mm, Titanium	4
	<b>TI-1131.32</b>	2.0mm Wise-Lock Screws, Self-Tapping, (Star Head), Length 32mm, Titanium	2
	<b>TI-1131.34</b>	2.0mm Wise-Lock Screws, Self-Tapping, (Star Head), Length 34mm, Titanium	2
	<b>TI-1131.36</b>	2.0mm Wise-Lock Screws, Self-Tapping, (Star Head), Length 36mm, Titanium	2
<b>TI-1131.38</b>	2.0mm Wise-Lock Screws, Self-Tapping, (Star Head), Length 38mm, Titanium	2	

**1138-10** Container with Tray and Lid For 2.4mm Implant & Instrument Set

**Instruments for 2.4mm Wise-Lock Modular Hand System**

Code	Items	Qty
<b>1137-01</b>	Self-Centering Double Drill Guide Ø2.4/1.8mm	1
<b>1137-02</b>	Wise-Lock Drill Sleeve 2.4mm For Drill Bit Ø1.8mm	2
<b>1136-06</b>	Countersink For 2.0/2.4/2.7mm Screws	1
<b>1137-03</b>	Bending Pin With Thread For 2.4mm/2.7mm Wise-Lock Plates	2
<b>1137-04</b>	Drill Bit Quick Coupling Ø1.8mm x Length 110/82mm, 2-Flute	2
<b>1137-05</b>	Drill Bit Quick Coupling Ø2.4mm x Length 100/73mm, 2-Flute	2
<b>1137-07</b>	Screwdriver Shaft, T8 For 2.4mm/2.7mm Screws	1
<b>1137-08</b>	Holding Sleeve For 2.4mm Cortical Screws	1
<b>1137-09</b>	Holding Sleeve For 2.4/2.7mm Wise-Lock Screws	1
<b>1138-10</b>	Container with Tray and Lid For 2.4mm Implant & Instrument Set	1

**1138-10 Container with Tray and Lid For 2.4mm Implant & Instrument Set**

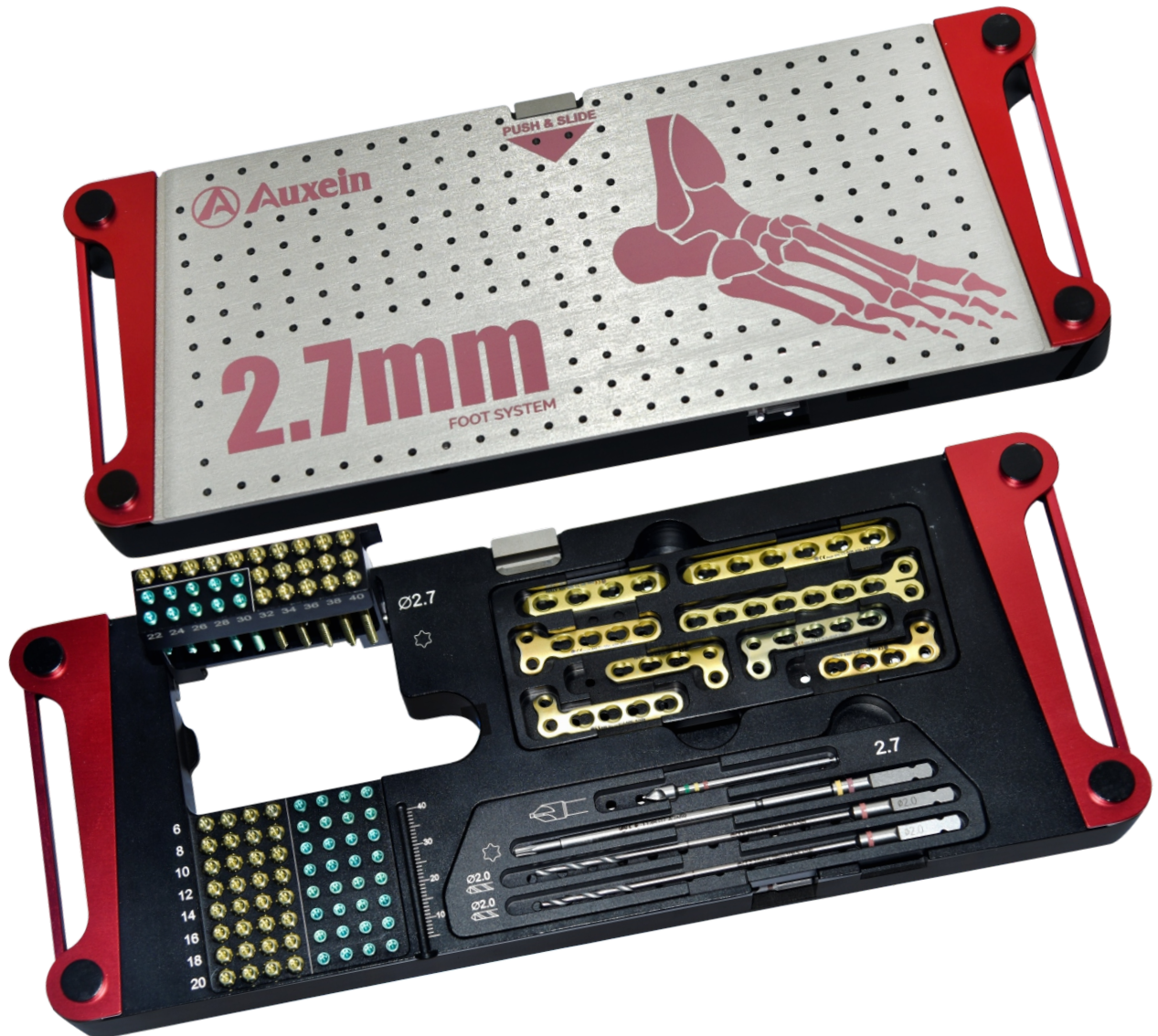
<b>Implants For 2.4mm Wise-lock Modular Hand System</b>				
	<b>Code</b>	<b>Items</b>	<b>Qty</b>	
Plates	<b>TI-505.304</b>	2.4mm Wise-Lock Plate, Straight, 4 Holes	1	
	<b>TI-505.306</b>	2.4mm Wise-Lock Plate, Straight, 6 Holes	1	
	<b>TI-505.308</b>	2.4mm Wise-Lock Plate, Straight, 8 Holes	1	
	<b>TI-555.312</b>	2.4mm Wise-Lock Adaption Plate, Straight, 12 Holes	1	
	<b>TI-559.307</b>	2.4mm Wise-Lock Condylar Plate, (2 Head Holes), 7 Holes	1	
	<b>TI-556.307</b>	2.4mm Wise-Lock T-Plate, (3 Head Holes), 7 Holes	1	
Screws	<b>TI-1144.06</b>	2.4mm Cortical Screws, Self-Tapping, (Star Head), Length 6mm, Titanium	4	
	<b>TI-1144.07</b>	2.4mm Cortical Screws, Self-Tapping, (Star Head), Length 7mm, Titanium	4	
	<b>TI-1144.08</b>	2.4mm Cortical Screws, Self-Tapping, (Star Head), Length 8mm, Titanium	4	
	<b>TI-1144.09</b>	2.4mm Cortical Screws, Self-Tapping, (Star Head), Length 9mm, Titanium	4	
	<b>TI-1144.10</b>	2.4mm Cortical Screws, Self-Tapping, (Star Head), Length 10mm, Titanium	4	
	<b>TI-1144.11</b>	2.4mm Cortical Screws, Self-Tapping, (Star Head), Length 11mm, Titanium	4	
	<b>TI-1144.12</b>	2.4mm Cortical Screws, Self-Tapping, (Star Head), Length 12mm, Titanium	4	
	<b>TI-1144.13</b>	2.4mm Cortical Screws, Self-Tapping, (Star Head), Length 13mm, Titanium	4	
	<b>TI-1144.14</b>	2.4mm Cortical Screws, Self-Tapping, (Star Head), Length 14mm, Titanium	4	
	<b>TI-1144.16</b>	2.4mm Cortical Screws, Self-Tapping, (Star Head), Length 16mm, Titanium	4	
	<b>TI-1144.18</b>	2.4mm Cortical Screws, Self-Tapping, (Star Head), Length 18mm, Titanium	4	
	<b>TI-1144.20</b>	2.4mm Cortical Screws, Self-Tapping, (Star Head), Length 20mm, Titanium	2	
	<b>TI-1144.22</b>	2.4mm Cortical Screws, Self-Tapping, (Star Head), Length 22mm, Titanium	2	
	<b>TI-1144.24</b>	2.4mm Cortical Screws, Self-Tapping, (Star Head), Length 24mm, Titanium	2	
	<b>TI-1144.26</b>	2.4mm Cortical Screws, Self-Tapping, (Star Head), Length 26mm, Titanium	2	
	<b>TI-1144.28</b>	2.4mm Cortical Screws, Self-Tapping, (Star Head), Length 28mm, Titanium	2	
	<b>TI-1144.30</b>	2.4mm Cortical Screws, Self-Tapping, (Star Head), Length 30mm, Titanium	2	
	<b>TI-1144.32</b>	2.4mm Cortical Screws, Self-Tapping, (Star Head), Length 32mm, Titanium	3	
	<b>TI-1144.34</b>	2.4mm Cortical Screws, Self-Tapping, (Star Head), Length 34mm, Titanium	3	
	<b>TI-1144.36</b>	2.4mm Cortical Screws, Self-Tapping, (Star Head), Length 36mm, Titanium	3	
	<b>TI-1144.38</b>	2.4mm Cortical Screws, Self-Tapping, (Star Head), Length 38mm, Titanium	3	
	<b>TI-1144.40</b>	2.4mm Cortical Screws, Self-Tapping, (Star Head), Length 40mm, Titanium	3	
	Screws	<b>TI-1145.06</b>	2.4mm Wise-Lock Screws, Self-Tapping, (Star Head), Length 6mm, Titanium	4
		<b>TI-1145.07</b>	2.4mm Wise-Lock Screws, Self-Tapping, (Star Head), Length 7mm, Titanium	4
<b>TI-1145.08</b>		2.4mm Wise-Lock Screws, Self-Tapping, (Star Head), Length 8mm, Titanium	4	
<b>TI-1145.09</b>		2.4mm Wise-Lock Screws, Self-Tapping, (Star Head), Length 9mm, Titanium	4	
<b>TI-1145.10</b>		2.4mm Wise-Lock Screws, Self-Tapping, (Star Head), Length 10mm, Titanium	4	
<b>TI-1145.11</b>		2.4mm Wise-Lock Screws, Self-Tapping, (Star Head), Length 11mm, Titanium	4	
<b>TI-1145.12</b>		2.4mm Wise-Lock Screws, Self-Tapping, (Star Head), Length 12mm, Titanium	4	
<b>TI-1145.13</b>		2.4mm Wise-Lock Screws, Self-Tapping, (Star Head), Length 13mm, Titanium	4	
<b>TI-1145.14</b>		2.4mm Wise-Lock Screws, Self-Tapping, (Star Head), Length 14mm, Titanium	4	
<b>TI-1145.16</b>		2.4mm Wise-Lock Screws, Self-Tapping, (Star Head), Length 16mm, Titanium	4	
<b>TI-1145.18</b>		2.4mm Wise-Lock Screws, Self-Tapping, (Star Head), Length 18mm, Titanium	4	
<b>TI-1145.20</b>		2.4mm Wise-Lock Screws, Self-Tapping, (Star Head), Length 20mm, Titanium	2	
<b>TI-1145.22</b>		2.4mm Wise-Lock Screws, Self-Tapping, (Star Head), Length 22mm, Titanium	2	
<b>TI-1145.24</b>		2.4mm Wise-Lock Screws, Self-Tapping, (Star Head), Length 24mm, Titanium	2	
<b>TI-1145.26</b>		2.4mm Wise-Lock Screws, Self-Tapping, (Star Head), Length 26mm, Titanium	2	
<b>TI-1145.28</b>		2.4mm Wise-Lock Screws, Self-Tapping, (Star Head), Length 28mm, Titanium	2	
<b>TI-1145.30</b>		2.4mm Wise-Lock Screws, Self-Tapping, (Star Head), Length 30mm, Titanium	2	

**1138-11** Container with Tray and Lid For 2.7mm Implant & Instrument Set

**Instruments For 2.7mm Wise-lock Modular Foot System**

Code	Items	Qty
<b>1137-07</b>	Screwdriver Shaft, T8 For 2.4mm/2.7mm Screws	1
<b>1137-03</b>	Bending Pin With Thread For 2.4mm/2.7mm Wise-Lock Plates	2
<b>1137-09</b>	Holding Sleeve For 2.4/2.7mm Wise-Lock Screws	1
<b>1136-06</b>	Countersink For 2.0/2.4/2.7mm Screws	1
<b>1138-01</b>	Self-Centering Double Drill Guide Ø2.7/2.0mm	1
<b>1138-02</b>	Wise-Lock Drill Sleeve 2.7mm For Drill Bits Ø2.0mm	2
<b>1138-04</b>	Drill Bit Quick Coupling Ø2.0mm x Length 110mm, 2-Flute	2
<b>1138-05</b>	Drill Bit Quick Coupling Ø2.7mm x Length 102mm, 2-Flute	2
<b>1138-41</b>	Holding Sleeve For 2.7mm Cortical Screws	1
<b>1138-11</b>	Container with Tray and Lid For 2.7mm Implant & Instrument Set	1

**1138-11 Container with Tray and Lid For 2.7mm Implant & Instrument Set**

<b>Instruments For 2.7mm Wise-lock Modular Foot System</b>				
	<b>Code</b>	<b>Items</b>	<b>Qty</b>	
Plates	<b>TI-505.404</b>	2.7mm Wise-Lock Plate, Straight, 4 Holes	1	
	<b>TI-505.406</b>	2.7mm Wise-Lock Plate, Straight, 6 Holes	1	
	<b>TI-559.407</b>	2.7mm Wise-Lock Condylar Plate, (2 Head Holes), 7 Holes	1	
	<b>TI-556.404</b>	2.7mm Wise-Lock T-Plate, (2 Head Holes), 4 Holes	1	
	<b>TI-813.403L</b>	2.7mm Wise-Lock L-Plate, (2 Head Holes), 3 Holes - Left	1	
	<b>TI-813.404L</b>	2.7mm Wise-Lock L-Plate, (2 Head Holes), 4 Holes - Left	1	
	<b>TI-813.403R</b>	2.7mm Wise-Lock L-Plate, (2 Head Holes), 3 Holes - Right	1	
	<b>TI-813.404R</b>	2.7mm Wise-Lock L-Plate, (2 Head Holes), 4 Holes - Right	1	
Screws	<b>TI-1242.06</b>	2.7mm Cortical Screws, Self-Tapping, (Star Head), Length 6mm, Titanium	4	
	<b>TI-1242.08</b>	2.7mm Cortical Screws, Self-Tapping, (Star Head), Length 8mm, Titanium	4	
	<b>TI-1242.10</b>	2.7mm Cortical Screws, Self-Tapping, (Star Head), Length 10mm, Titanium	4	
	<b>TI-1242.12</b>	2.7mm Cortical Screws, Self-Tapping, (Star Head), Length 12mm, Titanium	4	
	<b>TI-1242.14</b>	2.7mm Cortical Screws, Self-Tapping, (Star Head), Length 14mm, Titanium	4	
	<b>TI-1242.16</b>	2.7mm Cortical Screws, Self-Tapping, (Star Head), Length 16mm, Titanium	4	
	<b>TI-1242.18</b>	2.7mm Cortical Screws, Self-Tapping, (Star Head), Length 18mm, Titanium	4	
	<b>TI-1242.20</b>	2.7mm Cortical Screws, Self-Tapping, (Star Head), Length 20mm, Titanium	4	
	<b>TI-1242.22</b>	2.7mm Cortical Screws, Self-Tapping, (Star Head), Length 22mm, Titanium	1	
	<b>TI-1242.24</b>	2.7mm Cortical Screws, Self-Tapping, (Star Head), Length 24mm, Titanium	1	
	<b>TI-1242.26</b>	2.7mm Cortical Screws, Self-Tapping, (Star Head), Length 26mm, Titanium	1	
	<b>TI-1242.28</b>	2.7mm Cortical Screws, Self-Tapping, (Star Head), Length 28mm, Titanium	1	
	<b>TI-1242.30</b>	2.7mm Cortical Screws, Self-Tapping, (Star Head), Length 30mm, Titanium	1	
	<b>TI-1242.32</b>	2.7mm Cortical Screws, Self-Tapping, (Star Head), Length 32mm, Titanium	4	
	<b>TI-1242.34</b>	2.7mm Cortical Screws, Self-Tapping, (Star Head), Length 34mm, Titanium	4	
	<b>TI-1242.36</b>	2.7mm Cortical Screws, Self-Tapping, (Star Head), Length 36mm, Titanium	4	
	<b>TI-1242.38</b>	2.7mm Cortical Screws, Self-Tapping, (Star Head), Length 38mm, Titanium	4	
	<b>TI-1242.40</b>	2.7mm Cortical Screws, Self-Tapping, (Star Head), Length 40mm, Titanium	4	
	Screws	<b>TI-1241.06</b>	2.7mm Wise-Lock Screws, Self-Tapping, (Star Head), Length 6mm, Titanium	4
		<b>TI-1241.07</b>	2.7mm Wise-Lock Screws, Self-Tapping, (Star Head), Length 7mm, Titanium	4
<b>TI-1241.08</b>		2.7mm Wise-Lock Screws, Self-Tapping, (Star Head), Length 8mm, Titanium	4	
<b>TI-1241.09</b>		2.7mm Wise-Lock Screws, Self-Tapping, (Star Head), Length 9mm, Titanium	4	
<b>TI-1241.10</b>		2.7mm Wise-Lock Screws, Self-Tapping, (Star Head), Length 10mm, Titanium	4	
<b>TI-1241.12</b>		2.7mm Wise-Lock Screws, Self-Tapping, (Star Head), Length 12mm, Titanium	4	
<b>TI-1241.14</b>		2.7mm Wise-Lock Screws, Self-Tapping, (Star Head), Length 14mm, Titanium	4	
<b>TI-1241.16</b>		2.7mm Wise-Lock Screws, Self-Tapping, (Star Head), Length 16mm, Titanium	4	
<b>TI-1241.18</b>		2.7mm Wise-Lock Screws, Self-Tapping, (Star Head), Length 18mm, Titanium	4	
<b>TI-1241.20</b>		2.7mm Wise-Lock Screws, Self-Tapping, (Star Head), Length 20mm, Titanium	4	
<b>TI-1241.22</b>		2.7mm Wise-Lock Screws, Self-Tapping, (Star Head), Length 22mm, Titanium	2	
<b>TI-1241.24</b>		2.7mm Wise-Lock Screws, Self-Tapping, (Star Head), Length 24mm, Titanium	2	
<b>TI-1241.26</b>		2.7mm Wise-Lock Screws, Self-Tapping, (Star Head), Length 26mm, Titanium	2	
<b>TI-1241.28</b>	2.7mm Wise-Lock Screws, Self-Tapping, (Star Head), Length 28mm, Titanium	2		
<b>TI-1241.30</b>	2.7mm Wise-Lock Screws, Self-Tapping, (Star Head), Length 30mm, Titanium	2		



**1138-12** Handle with Mini Quick Coupling, for Hand & Foot System



**1138-13** Handle With Quick Coupling (Straight), for Hand & Foot System



**1138-14** Depth Gauge measuring upto 30mm, for Hand & Foot System



**1138-15** Depth Gauge measuring upto 50mm, for Hand & Foot System



**1138-17** Screw Holding Forcecp, for Hand & Foot System



**1138-18** Cutting Forcecp, for Hand & Foot System



**1138-23** Torque Limiting attachment, 0.8Nm, with AO quick coupling - Hand & Foot System



**1138-24** Torque Limiting attachment, 0.4Nm, with AO Quick Coupling - Hand & Foot System



**1138-26** Hohmann Retractor, 15mm, for Hand & Foot System



**1138-27** Hohmann Retractor, 6.5mm, for Hand & Foot System



**1138-28** Periosteal Elevator, Round, for Hand & Foot System



**1138-29** Periosteal Elevator, Flat, for Hand & Foot System



**1138-30** Cutting Plier (For pins and plates), for Hand & Foot System



**1138-31** Bending Pliers for Hand & Foot System



**1138-33** Reduction Forcep, Pointed, Small, for Hand & Foot System



**1138-36** Plate File, for Hand & Foot System



**1138-37** Reduction Forcep, Serrated Jaws, for Hand & Foot System



**1138-38** Star Screwdriver for 1.5mm Screws - Hand & Foot System



**1138-39**

Star Screwdriver for 2.0mm Screws - Hand & Foot System



**1138-40**

Star Screwdriver for 2.4/2.7mm Screws - Hand & Foot System



**1138-35**

Container for Hand & Foot Instrument & Implant set

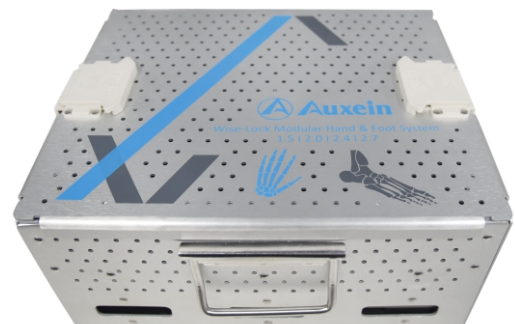

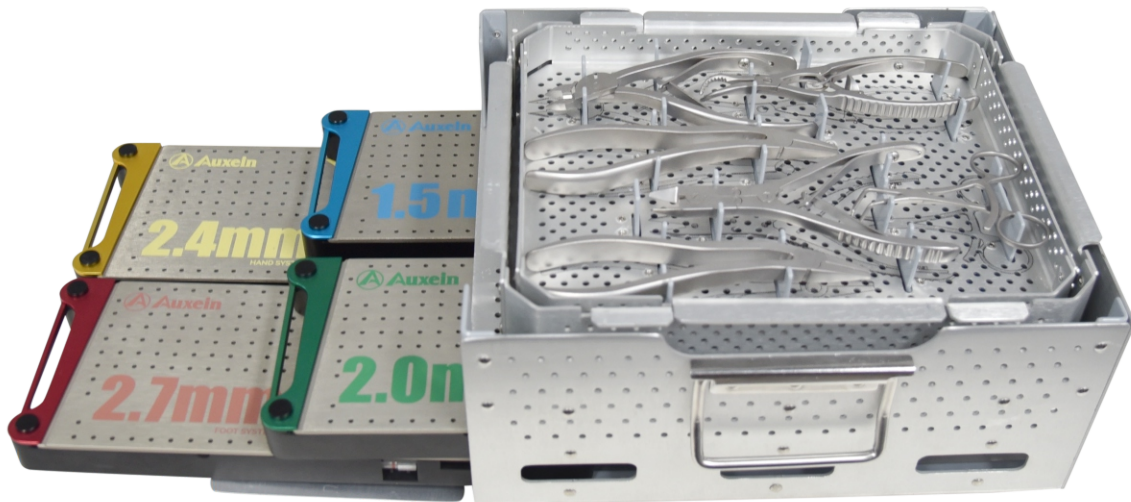
**5001-000** Modular Hand & Foot System Instrument Set

Code	Items	Qty
1138-12	Handle with Mini Quick Coupling, for Hand & Foot System	1
1138-13	Handle With Quick Coupling (Straight), for Hand & Foot System	1
1138-14	Depth Gauge measuring upto 30mm, for Hand & Foot System	1
1138-15	Depth Gauge measuring upto 50mm, for Hand & Foot System	1
1138-17	Screw Holding Forcep, for Hand & Foot System	1
1138-18	Cutting Forcep, for Hand & Foot System	1
1138-23	Torque Limiting attachment, 0.8Nm, with AO quick coupling - Hand & Foot System	1
1138-24	Torque Limiting attachment, 0.4Nm, with AO Quick Coupling - Hand & Foot System	1
1138-26	Hohmann Retractor, 15mm, for Hand & Foot System	1
1138-27	Hohmann Retractor, 6.5mm, for Hand & Foot System	1
1138-28	Periosteal Elevator, Round, for Hand & Foot System	1
1138-29	Periosteal Elevator, Flat , for Hand & Foot System	1
1138-30	Cutting Plier (For pins and plates), for Hand & Foot System	1
1138-31	Bending Pliers for Hand & Foot System	2
1138-33	Reduction Forcep, Pointed, Small, for Hand & Foot System	1
1138-36	Plate File, for Hand & Foot System	1
1138-37	Reduction Forcep, Serrated Jaws, for Hand & Foot System	1
1138-38	Star Screwdriver for 1.5mm Screws - Hand & Foot System	1
1138-39	Star Screwdriver for 2.0mm Screws - Hand & Foot System	1
1138-40	Star Screwdriver for 2.4/2.7mm Screws - Hand & Foot System	1
1138-35	Container for Hand & Foot Instrument & Implant set	1

**Instruments for 1.5mm Wise-Lock Modular Hand System**

Code	Items	Qty
<b>1135-01</b>	Double Drill Guide Ø1.5/1.1mm	1
<b>1135-02</b>	Wise-Lock Drill Sleeve 1.5mm For Drill Bit Ø1.1mm	2
<b>1135-03</b>	Bending Pin With Thread For 1.5mm Wise-Lock Plates	2
<b>1135-04</b>	Drill Bit Quick Coupling Ø1.1mm x Length 75/61mm, 2-Flute	2
<b>1135-05</b>	Drill Bit Quick Coupling Ø1.5mm x Length 65/50mm, 2-Flute	2
<b>1135-06</b>	Countersink For 1.5mm Screws	1
<b>1135-07</b>	Screwdriver Shaft, T4 for 1.5mm Screws	1
<b>1135-08</b>	Screw Holding Sleeve for 1.5mm Cortical Screws	1
<b>1135-09</b>	Screw Holding Sleeve for 1.5mm Wise-Lock Screws	1
<b>1138-08</b>	Container with Tray and Lid For 1.5mm Implant & Instrument Set	1

**Instruments for 2.0mm Wise-Lock Modular Hand System**

Code	Items	Qty
<b>1136-01</b>	Self-Centering Double Drill Guide Ø2.0/1.5mm	1
<b>1136-02</b>	Wise-Lock Drill Sleeve 2.0mm, For Drill Bit, Ø1.5mm	2
<b>1136-03</b>	Bending Pin with thread For 2.0mm Wise-Lock Plates	2
<b>1136-04</b>	Drill Bit Quick Coupling Ø1.5mm x Length 96/82mm, 2-Flute	2
<b>1136-05</b>	Drill Bit Quick Coupling Ø2.0mm x Length 67/55mm, 2-Flute	2
<b>1136-06</b>	Countersink For 2.0/2.4/2.7mm Screws	1
<b>1136-10</b>	Screwdriver Shaft, T6 for 2.0mm Screws	1
<b>1136-08</b>	Screw Holding Sleeve For 2.0mm Cortical Screws	1
<b>1136-09</b>	Screw Holding Sleeve For 2.0mm Wise-Lock Screws	1
<b>1138-09</b>	Container with Tray and Lid For 2.0mm Implant & Instrument Set	1

**Instruments for 2.4mm Wise-Lock Modular Hand System**

Code	Items	Qty
<b>1137-01</b>	Self-Centering Double Drill Guide Ø2.4/1.8mm	1
<b>1137-02</b>	Wise-Lock Drill Sleeve 2.4mm For Drill Bit Ø1.8mm	2
<b>1136-06</b>	Countersink For 2.0/2.4/2.7mm Screws	1
<b>1137-03</b>	Bending Pin With Thread For 2.4mm/2.7mm Wise-Lock Plates	2
<b>1137-04</b>	Drill Bit Quick Coupling Ø1.8mm x Length 110/82mm, 2-Flute	2
<b>1137-05</b>	Drill Bit Quick Coupling Ø2.4mm x Length 100/73mm, 2-Flute	2
<b>1137-07</b>	Screwdriver Shaft, T8 For 2.4mm/2.7mm Screws	1
<b>1137-08</b>	Holding Sleeve For 2.4mm Cortical Screws	1
<b>1137-09</b>	Holding Sleeve For 2.4/2.7mm Wise-Lock Screws	1
<b>1138-10</b>	Container with Tray and Lid For 2.4mm Implant & Instrument Set	1

**Instruments For 2.7mm Wise-lock Modular Foot System**

Code	Items	Qty
<b>1137-07</b>	Screwdriver Shaft, T8 For 2.4mm/2.7mm Screws	1
<b>1137-03</b>	Bending Pin With Thread For 2.4mm/2.7mm Wise-Lock Plates	2
<b>1137-09</b>	Holding Sleeve For 2.4/2.7mm Wise-Lock Screws	1
<b>1136-06</b>	Countersink For 2.0/2.4/2.7mm Screws	1
<b>1138-01</b>	Self-Centering Double Drill Guide Ø2.7/2.0mm	1
<b>1138-02</b>	Wise-Lock Drill Sleeve 2.7mm For Drill Bits Ø2.0mm	2
<b>1138-04</b>	Drill Bit Quick Coupling Ø2.0mm x Length 110mm, 2-Flute	2
<b>1138-05</b>	Drill Bit Quick Coupling Ø2.7mm x Length 102mm, 2-Flute	2
<b>1138-41</b>	Holding Sleeve For 2.7mm Cortical Screws	1
<b>1138-11</b>	Container with Tray and Lid For 2.7mm Implant & Instrument Set	1



**USA**

Auxein Inc.  
1500 Nw 89th Court, Suite 205,  
Doral, Florida 33172  
Tel: +1 305 395 6062  
E Fax: +1 305 395 6262  
Email: USoffice@auxein.com

**MEXICO**

Auxein México, S.A. de C.V.  
Tepic 139 int 801, Colonia Roma Sur,  
Alcaldía Cuauhtémoc, CDMX,  
México, C.P. 06760  
Tel: +521 55 7261 0318  
Email: info@auxein.mx

**INDIA**

Auxein Medical Pvt. Ltd.  
Plot No. 168-169-170, Phase-4,  
Kundli Industrial Area,  
HSIIDC, Sector-57, Sonapat - 131028, Haryana  
Tel: +91 99106 43638 | Fax: +91 86077 70197  
Email: info@auxein.com