

WISE-LOCK SYSTEM

# WISE-LOCK

Cable Plate System





# about us

Auxein Medical is an integrated, research based, orthopaedic Implants & instruments manufacturing company, producing a wide range of quality, affordable generic implants, trusted by healthcare professionals and patients across geographies. It is the Company's constant endeavor to provide a wide basket of generic and our innovator products that exceed the highest expectations of customers in term of quality and safety. The company has world-class manufacturing unit established in india and serves customers in over 75 countries worldwide.

## Our Achievements



# **Orthopaedic Implants**

**5.0mm Wise-Lock Cable Prosthesis and Revision Femur Plate, Titanium**



5.0mm Wise-Lock Cable Prosthesis and Revision Femur Plate

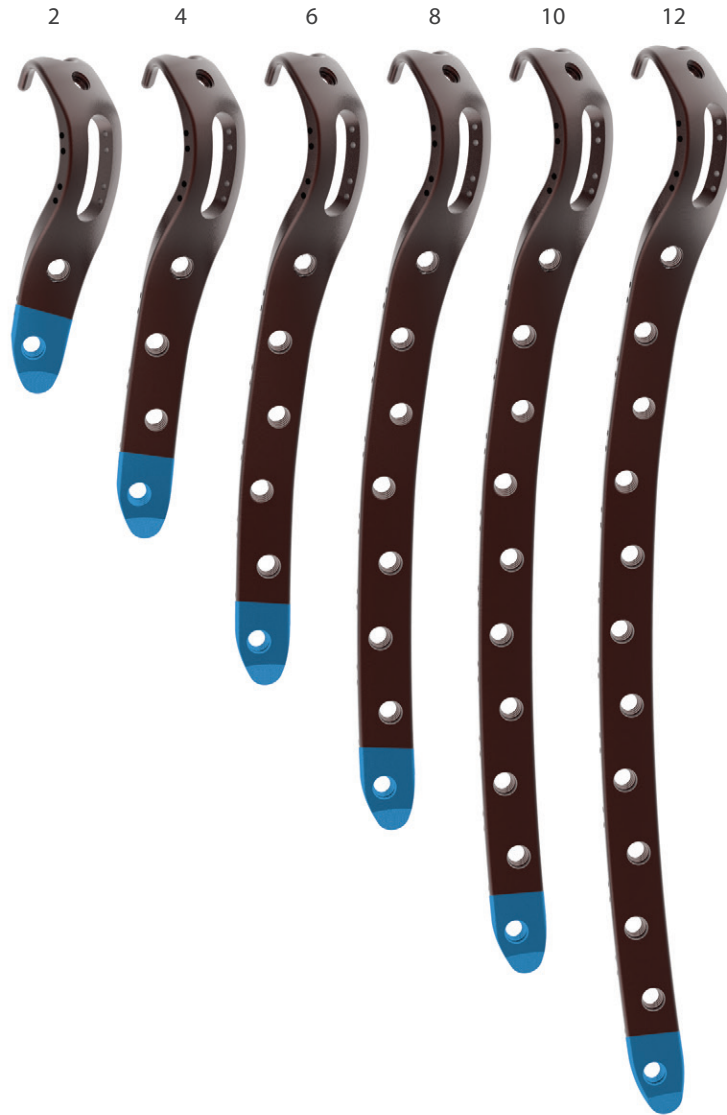

Hooks



Compression & Locking Hole

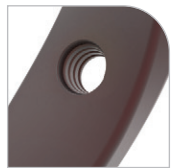

Holes for Cable



**STERILE**



Holes	Left Direction	Right Direction
2	<b>10-018-02LTI-S</b>	<b>10-018-02RTI-S</b>
4	<b>10-018-04LTI-S</b>	<b>10-018-04RTI-S</b>
6	<b>10-018-06LTI-S</b>	<b>10-018-06RTI-S</b>
8	<b>10-018-08LTI-S</b>	<b>10-018-08RTI-S</b>
10	<b>10-018-10LTI-S</b>	<b>10-018-10RTI-S</b>
12	<b>10-018-12LTI-S</b>	<b>10-018-12RTI-S</b>

Holes	Left Direction	Right Direction
2	<b>10-018-02LTI</b>	<b>10-018-02RTI</b>
4	<b>10-018-04LTI</b>	<b>10-018-04RTI</b>
6	<b>10-018-06LTI</b>	<b>10-018-06RTI</b>
8	<b>10-018-08LTI</b>	<b>10-018-08RTI</b>
10	<b>10-018-10LTI</b>	<b>10-018-10RTI</b>
12	<b>10-018-12LTI</b>	<b>10-018-12RTI</b>

**5.0mm Wise-Lock Cable Straight Plate, Titanium**

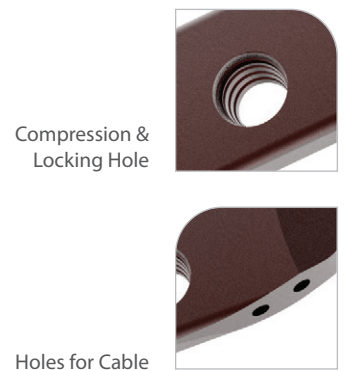

**5.0mm Wise-Lock Cable Straight Plate**

**STERILE**

Holes	Code
6	<b>10-043-06TI-S</b>
8	<b>10-043-08TI-S</b>
10	<b>10-043-10TI-S</b>



Holes	Code
6	<b>10-043-06TI</b>
8	<b>10-043-08TI</b>
10	<b>10-043-10TI</b>



**STERILE**

**Cable**

Codes	Dia	Length
10-019-500TI-S	1.0mm	500mm
10-020-500TI-S	1.7mm	500mm



**STERILE**

**Cable Connector Curved**

Codes	Dia
10-062-1.0TI-S	1.0mm
10-062-1.7TI-S	1.7mm



**STERILE**

**Bone Needle**

Codes	Dia	Length
10-022-150SS-S	1.5mm	150mm
10-022-250SS-S	1.5mm	250mm
10-023-400SS-S	1.8mm	400mm
10-024-150SS-S	2.0mm	150mm
10-024-400SS-S	2.0mm	400mm
10-024-450SS-S	2.0mm	450mm



**STERILE**

**Bone Needle with Hole**

Codes	Dia	Length
10-025-100SS-S	1.6mm	100mm
10-025-140SS-S	1.6mm	140mm
10-026-100SS-S	2.0mm	100mm
10-026-120SS-S	2.0mm	120mm
10-026-140SS-S	2.0mm	140mm
10-027-120SS-S	2.5mm	120mm
10-027-140SS-S	2.5mm	140mm



**Cable**

Codes	Dia	Length
<b>10-019-500TI</b>	1.0mm	500mm
<b>10-020-500TI</b>	1.7mm	500mm

**Cable Connector Curved**

Codes	Dia
<b>10-062-1.0TI</b>	1.0mm
<b>10-062-1.7TI</b>	1.7mm

**Bone Needle**

Codes	Dia	Length
<b>10-022-150SS</b>	1.5mm	150mm
<b>10-022-250SS</b>	1.5mm	250mm
<b>10-023-400SS</b>	1.8mm	400mm
<b>10-024-150SS</b>	2.0mm	150mm
<b>10-024-400SS</b>	2.0mm	400mm
<b>10-024-450SS</b>	2.0mm	450mm

**Bone Needle with Hole**

Codes	Dia	Length
<b>10-025-100SS</b>	1.6mm	100mm
<b>10-025-140SS</b>	1.6mm	140mm
<b>10-026-100SS</b>	2.0mm	100mm
<b>10-026-120SS</b>	2.0mm	120mm
<b>10-026-140SS</b>	2.0mm	140mm
<b>10-027-120SS</b>	2.5mm	120mm
<b>10-027-140SS</b>	2.5mm	140mm



5.0mm Wise-Lock Screw, Self-Tapping, (Hex Head)

**STERILE**



Length (mm)	Codes
12	TI-119.012-S
14	TI-119.014-S
16	TI-119.016-S
18	TI-119.018-S
20	TI-119.020-S
22	TI-119.022-S
24	TI-119.024-S
26	TI-119.026-S
28	TI-119.028-S
30	TI-119.030-S
32	TI-119.032-S
34	TI-119.034-S
36	TI-119.036-S
38	TI-119.038-S
40	TI-119.040-S
42	TI-119.042-S
44	TI-119.044-S
46	TI-119.046-S
48	TI-119.048-S
50	TI-119.050-S
52	TI-119.052-S
54	TI-119.054-S
56	TI-119.056-S
58	TI-119.058-S
60	TI-119.060-S
65	TI-119.065-S
70	TI-119.070-S
75	TI-119.075-S
80	TI-119.080-S
85	TI-119.085-S
90	TI-119.090-S

Length (mm)	Codes
12	TI-119.012
14	TI-119.014
16	TI-119.016
18	TI-119.018
20	TI-119.020
22	TI-119.022
24	TI-119.024
26	TI-119.026
28	TI-119.028
30	TI-119.030
32	TI-119.032
34	TI-119.034
36	TI-119.036
38	TI-119.038
40	TI-119.040
42	TI-119.042
44	TI-119.044
46	TI-119.046
48	TI-119.048
50	TI-119.050
52	TI-119.052
54	TI-119.054
56	TI-119.056
58	TI-119.058
60	TI-119.060
65	TI-119.065
70	TI-119.070
75	TI-119.075
80	TI-119.080
85	TI-119.085
90	TI-119.090



**10-049 Implant Box for 5.0mm Wise-Lock Cable Plate Implant Set**

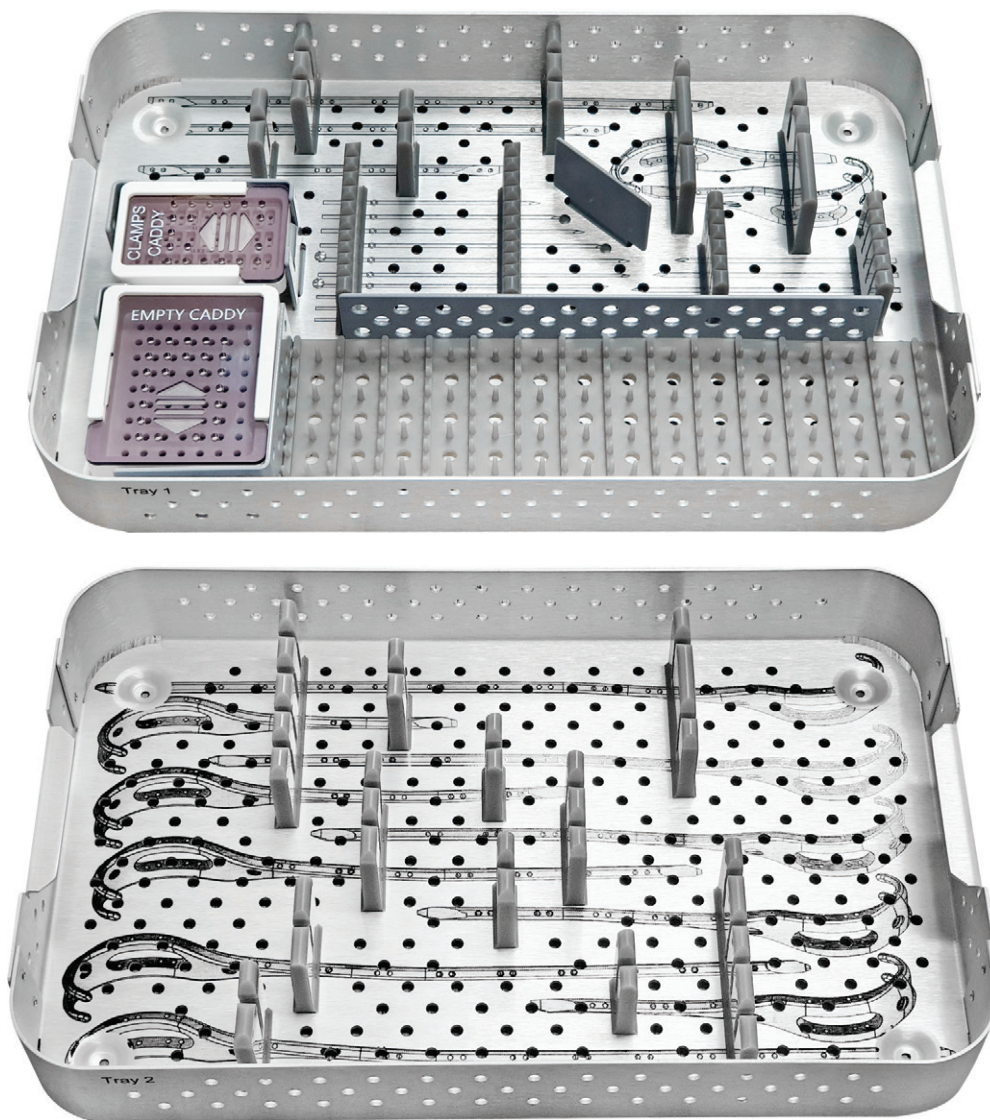

**10-049 5.0mm Wise-Lock Cable Plate Implant Set**

Codes	Set Consisting of:	Units
<b>10-018-02LTI</b>	5.0mm Wise-Lock Cable Prosthesis and Revision Femur Plate, Left, 2 Holes, Titanium	1
<b>10-018-04LTI</b>	5.0mm Wise-Lock Cable Prosthesis and Revision Femur Plate, Left, 4 Holes, Titanium	1
<b>10-018-06LTI</b>	5.0mm Wise-Lock Cable Prosthesis and Revision Femur Plate, Left, 6 Holes, Titanium	1
<b>10-018-08LTI</b>	5.0mm Wise-Lock Cable Prosthesis and Revision Femur Plate, Left, 8 Holes, Titanium	1
<b>10-018-10LTI</b>	5.0mm Wise-Lock Cable Prosthesis and Revision Femur Plate, Left, 10 Holes, Titanium	1
<b>10-018-12LTI</b>	5.0mm Wise-Lock Cable Prosthesis and Revision Femur Plate, Left, 12 Holes, Titanium	1
<b>10-018-02RTI</b>	5.0mm Wise-Lock Cable Prosthesis and Revision Femur Plate, Right, 2 Holes, Titanium	1
<b>10-018-04RTI</b>	5.0mm Wise-Lock Cable Prosthesis and Revision Femur Plate, Right, 4 Holes, Titanium	1
<b>10-018-06RTI</b>	5.0mm Wise-Lock Cable Prosthesis and Revision Femur Plate, Right, 6 Holes, Titanium	1
<b>10-018-08RTI</b>	5.0mm Wise-Lock Cable Prosthesis and Revision Femur Plate, Right, 8 Holes, Titanium	1
<b>10-018-10RTI</b>	5.0mm Wise-Lock Cable Prosthesis and Revision Femur Plate, Right, 10 Holes, Titanium	1
<b>10-018-12RTI</b>	5.0mm Wise-Lock Cable Prosthesis and Revision Femur Plate, Right, 12 Holes, Titanium	1
<b>10-043-06TI</b>	5.0mm Wise-Lock Cable Straight Plate, 6 Holes, Titanium	1
<b>10-043-08TI</b>	5.0mm Wise-Lock Cable Straight Plate, 8 Holes, Titanium	1
<b>10-043-10TI</b>	5.0mm Wise-Lock Cable Straight Plate, 10 Holes, Titanium	1
<b>10-062-1.0TI</b>	Cable Connector, Curved, Ø1.0mm, Titanium	1
<b>10-062-1.7TI</b>	Cable Connector, Curved, Ø1.7mm, Titanium	1
<b>10-022-150SS</b>	Bone Needle, Ø1.5mm x Length 150mm, Stainless Steel	2
<b>10-022-250SS</b>	Bone Needle, Ø1.5mm x Length 250mm, Stainless Steel	2
<b>10-023-400SS</b>	Bone Needle, Ø1.8mm x Length 400mm, Stainless Steel	2
<b>10-024-150SS</b>	Bone Needle, Ø2.0mm x Length 150mm, Stainless Steel	2
<b>10-024-400SS</b>	Bone Needle, Ø2.0mm x Length 400mm, Stainless Steel	2
<b>10-024-450SS</b>	Bone Needle, Ø2.0mm x Length 450mm, Stainless Steel	2
<b>10-025-100SS</b>	Bone Needle with Hole, Ø1.6mm x Length 100mm, Stainless Steel	2
<b>10-025-140SS</b>	Bone Needle with Hole, Ø1.6mm x Length 140mm, Stainless Steel	2
<b>10-026-100SS</b>	Bone Needle with Hole, Ø2.0mm x Length 100mm, Stainless Steel	2
<b>10-026-120SS</b>	Bone Needle with Hole, Ø2.0mm x Length 120mm, Stainless Steel	2
<b>10-026-140SS</b>	Bone Needle with Hole, Ø2.0mm x Length 140mm, Stainless Steel	2
<b>10-027-120SS</b>	Bone Needle with Hole, Ø2.5mm x Length 120mm, Stainless Steel	2
<b>10-027-140SS</b>	Bone Needle with Hole, Ø2.5mm x Length 140mm, Stainless Steel	2

**7-035-01** Flat Connector Crimper for Cable Plate



**7-035-02** Spicule Cutter for Cable Plate



**7-035-03** Cable Cutter for Cable Plate

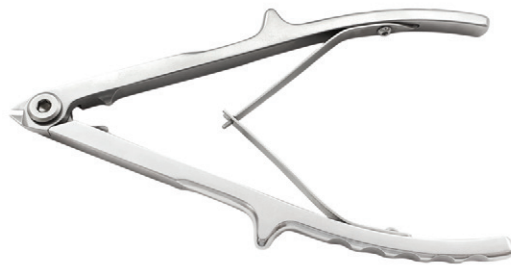

**7-035-04** Front Pressure Cable Lock, ID: Ø1.0mm, for Cable Plate



**7-035-05** Back Pressure Cable Lock, ID: Ø1.0mm, for Cable Plate



**7-035-06** Front Pressure Cable Lock, ID: Ø1.7mm, for Cable Plate

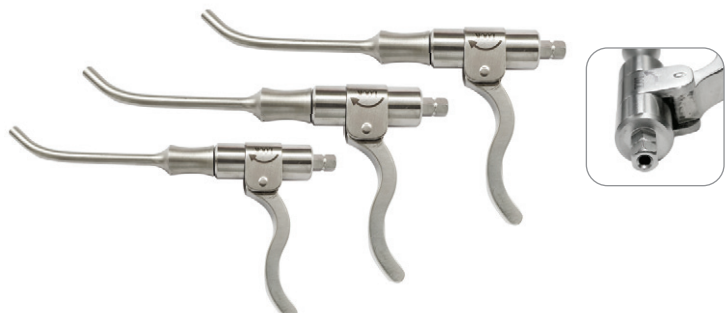

**7-035-07** Back Pressure Cable Lock, ID: Ø1.7mm, for Cable Plate



**7-035-08** Cable Tensioner for Cable Plate



**7-035-09** Cable Passer for Cable Plate



**7-035-10** Spicule Bender for Cable Plate



**7-035-11** Curved Needle Guide for Cable Plate



**7-035-12** Straight Needle Guide for Cable Plate

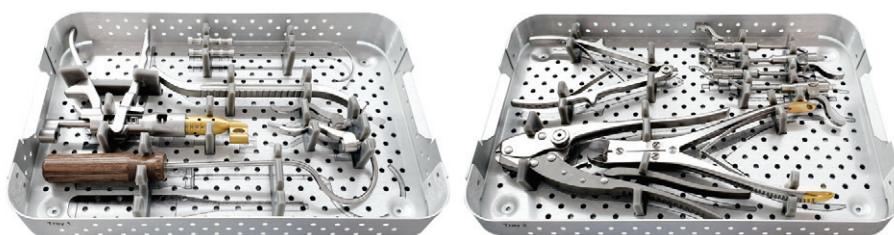

**7-035-13**      Impactor for Cable Plate**7-035-16**      Wire Tensioner for Cable Plate**7-035-14**      Trays for Cable Plate Instrument Set**7-035-15**      Container for Cable Plate Instrument Set



**7-035 Cable Plate Instrument Set**

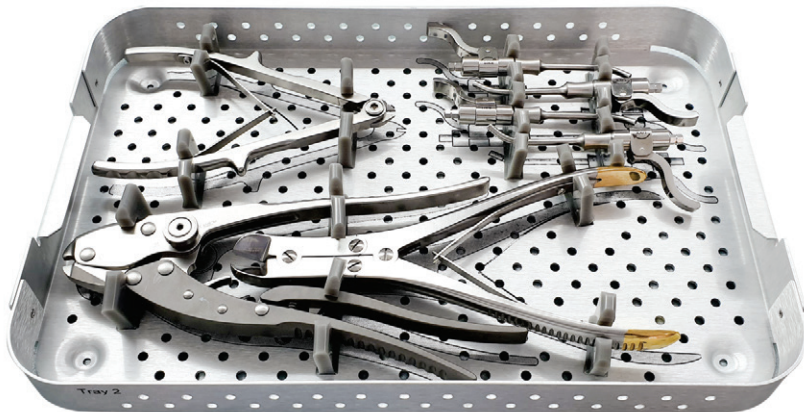
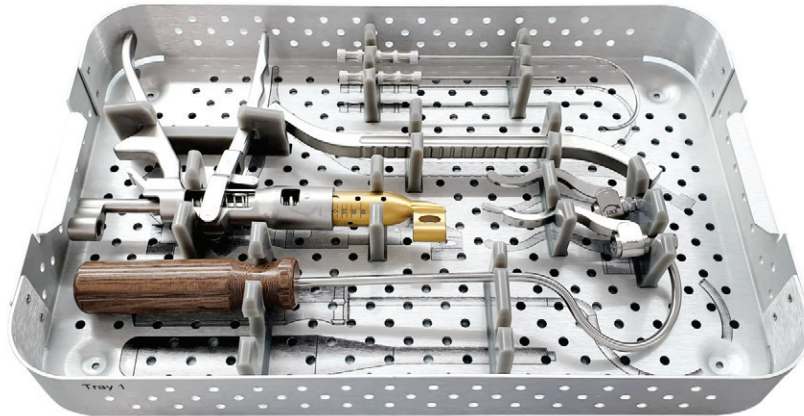

**7-035 Cable Plate Instrument Set**

Codes	Set Consisting of:	Units
<b>7-035-01</b>	Flat Connector Crimper for Cable Plate	1
<b>7-035-02</b>	Spicule Cutter for Cable Plate	1
<b>7-035-03</b>	Cable Cutter for Cable Plate	1
<b>7-035-04</b>	Front Pressure Cable Lock, ID: Ø1.0mm, for Cable Plate	1
<b>7-035-05</b>	Back Pressure Cable Lock, ID: Ø1.0mm, for Cable Plate	1
<b>7-035-06</b>	Front Pressure Cable Lock, ID: Ø1.7mm, for Cable Plate	3
<b>7-035-07</b>	Back Pressure Cable Lock, ID: Ø1.7mm, for Cable Plate	1
<b>7-035-08</b>	Cable Tensioner for Cable Plate	1
<b>7-035-09</b>	Cable Passer for Cable Plate	1
<b>7-035-10</b>	Spicule Bender for Cable Plate	1
<b>7-035-11</b>	Curved Needle Guide for Cable Plate	1
<b>7-035-12</b>	Straight Needle Guide for Cable Plate	1
<b>7-035-13</b>	Impactor for Cable Plate	1
<b>7-035-16</b>	Wire Tensioner for Cable Plate	1
<b>7-035-14</b>	Trays for Cable Plate Instrument Set	2
<b>7-035-15</b>	Container for Cable Plate Instrument Set	1





**USA**

Auxein Inc.  
1500 Nw 89th Court, Suite 107-108  
Doral, Florida 33172  
Tel: +1 305 395 6062  
E Fax: +1 305 395 6262  
Email: USoffice@auxein.com

**MEXICO**

Auxein México, S.A. de C.V.  
Tepic 139 int 801, Colonia Roma Sur,  
Alcaldía Cuauhtémoc, CDMX,  
México, C.P. 06760  
Tel: +521 55 7261 0318  
Email: info@auxein.mx

**INDIA**

Auxein Medical Pvt. Ltd.  
Plot No. 168-169-170, Phase-4,  
Kundli Industrial Area,  
HSIIDC, Sector-57, Sonapat - 131028, Haryana  
Tel: +91 99106 43638 | Fax: +91 86077 70197  
Email: info@auxein.com